

W

A

|

L

L

S

|

Cork Wall Coverings



DELIVERING NATURE



DELIVERING NATURE

GRANORTE



Nature is instinct, passion, without calculation, without hidden motives, without personal interests. Every day multitudes of flowers bloom, even if we don't watch them, birds sing in a delicious way, even if we don't listen them, thousands of plants grow without our knowledge, our life is filled with colours and scents given by nature, even if you don't ask nothing.

A S P O N T A N E O U S  
G E S T U R E

It is from an acorn that falls from the cork oak tree, that a new plant is born, in a spontaneous way. Reaching the mature age, well rooted in the earth, the cork oak lets himself be stripped off his dress, letting himself be seen inside, with his vital force, of orange colour, intense like the sun. And it regenerates itself, every nine years, giving us not only its bark, but also a better environment, full of biodiversity, a unique habitat in the world.

As a company that bases its action on the production of natural materials, we know that there must be no forcing, no pressure and no unkind gestures. The extent and limit of our activity is Nature itself, so, we make ethical choices that respect Nature and mankind. What we produce is simply the transformation of what Nature has given us, with a spontaneous gesture.

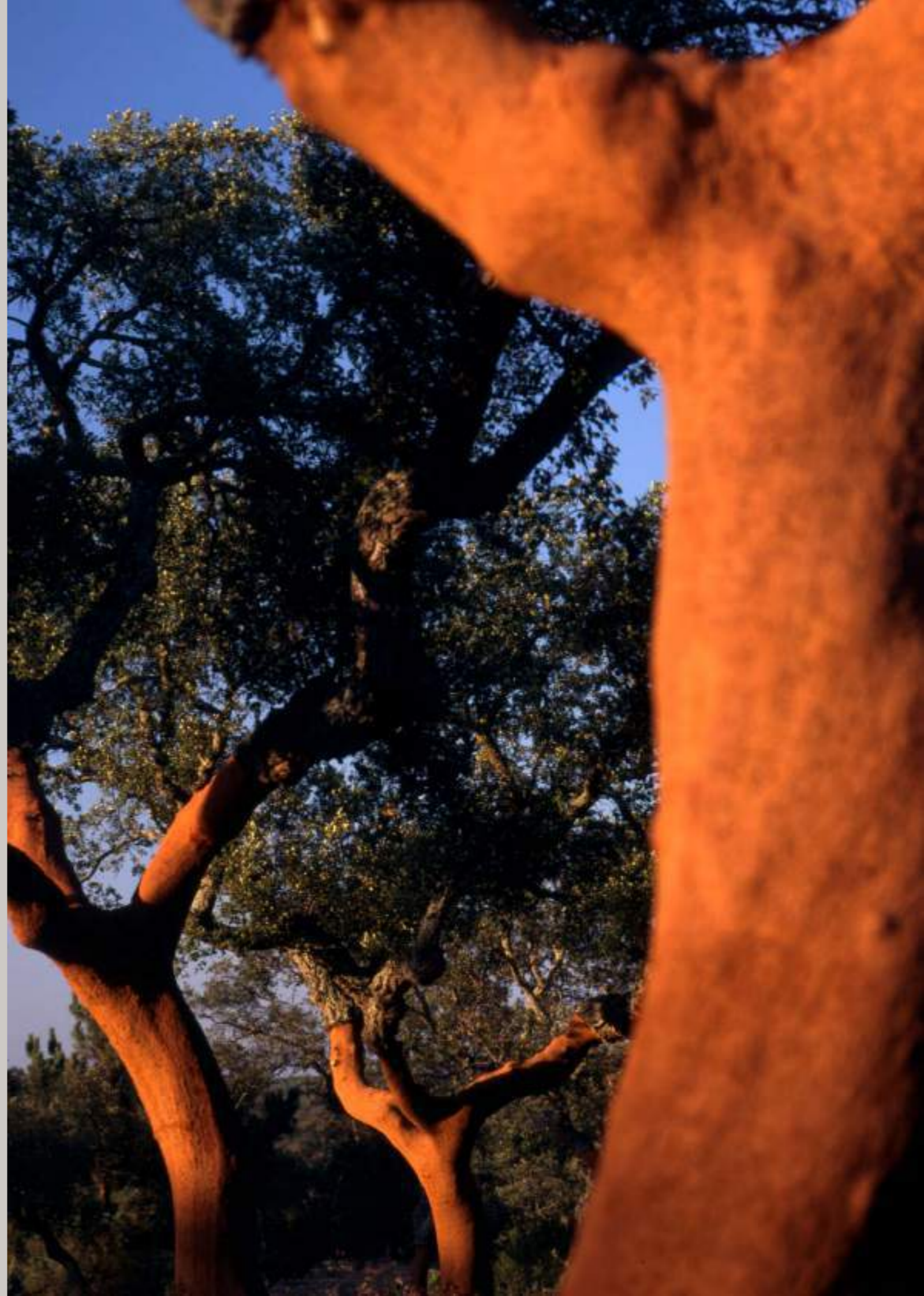



Cork, a 100% natural, renewable, biodegradable and fully recyclable material, has unique and inimitable properties: it is light, elastic, resilient, hypoallergenic, fire retardant, thermal and sound insulator. Moreover, it has remarkable sensory and emotional characteristics: it is comfortable, warm and pleasant to the touch.

## A U N I Q U E      N A T U R A L M A T E R I A L

No other product can be as sustainable as cork from the environmental perspective. Cork plays an important role in CO<sub>2</sub> sequestration serving as a barrier to climate change, given the carbon retention potential of 50 to 70 tons of CO<sub>2</sub> per ton of cork. Cork harvesting has no environmental impact and cork oak forests preserve biodiversity and combat desertification.

Every time we use a cork product, there is a direct contribution to the environment.

Cork's attributes cannot be found in any other single source, making it superior to many synthetic substitutes and an essential sustainable alternative for many purposes. Either natural or agglomerated, with cork grains obtained by recycling the by-products from cork transformation industry, it can be shaped, coloured, printed and engraved, offering an amazing diversity of options to explore the material in a surprisingly creative way.

For 50 years Granorte combines production with a culture rooted in sustainability and tradition. And we believe in the wisdom of a natural, time-honoured but renewed material: Cork.

Our products will never be as beautiful as the wonderful vibration of the natural cork bark texture, but we try, every day, to rediscover this wonderful raw material combining culture, sustainability and technical performance.

Our brand, “Delivering Nature”, is ecological,

G R A N O R T E ,

5 0 Y E A R S L O V I N G C O R K

creative and sophisticated, personifying our passion for cork and our determination to fascinate people, designing and creating stunning cork products that capture the imagination and inspire beautiful and eco-friendly interiors, contributing positively to a more sustainable planet.

Like trees, we have roots, firmly grounded in our values, quality, respect, progress, and our branches and leaves are our ambition to change the world of coverings.





Every time we return home, opening the door, we find our world, a comfortable atmosphere, the scents and sounds we immediately recognize, the shine in the eyes of our loved ones. Everything we receive at that moment is a magical game of the senses. It is Nature that gives it to us, especially if that atmosphere, that small world, is made of natural materials, in full respect of the larger world surrounding us.

Being green, sustainable, is not a fashion, it is a lifestyle choice.

## T H E   H O U S E   O F   N A T U R E

That life that we find every day when we open the front door. We take off our shoes, and walk on a floor that welcomes us with comfort and warmth, with a natural scent of clean air. Then, touching the wall we feel a surface that it is not only decorative, but which protects us from heat and cold, makes the annoying sounds more quiet, brings ourselves back to balance, making us understand that we do not live in a tree, but in a house full of nature.



A N E W M E A N I N G  
T O N A T U R A L  
A E S T H E T I C

D E C O D A L L E

For residential and commercial interiors.

Glued installation on walls.

28 textures/colours.

Dimensions: 600 x 300 x 3 mm.

PARAWAX matt coating.

*With the natural aesthetic of cork, DECODALLE wall tiles offer something new for high-end interiors.*

*Delivering a rich collection of decorative cork veneers, DECODALLE presents a variety of surfaces achievable in natural cork, not only intrinsically beautiful and diverse, but also warm, quiet and durable. DECODALLE allows interiors a powerful natural aesthetic without compromising function.*

No formaldehyde, PVC, softeners, heavy metals or other substances hazardous to health or the environment.

Very low VOC emissions in compliance with GreenGuard GOLD, AgBB scheme and French Classification A+.

Made with 90% of renewable and Recycled by-products of cork.

FSC® certified products are available upon request.





C o u n t r y

I v o r y









C E L E B R A T I N G  
N A T U R E ' S  
P E R F E C T  
I M P E R F E C T I O N

For residential and commercial interiors.

Glued installation on walls.

14 textures/colours.

Dimensions: 900 x 300 x 4 mm.

CORKGUARD® waterbased finish with  
CleanSurface powered by Microban®  
antimicrobial technology.

*Taking its name from the Japanese concept of wabi-sabi, which finds beauty in contrast and imperfection, WABI is a prime example of how sustainable materials can be combined with natural inspired aesthetics, its variants and nuances to create a real statement in interior design.*

*WABI is a result of the fusion of Nature and Material, connecting interiors to the outside world and the very nature from around the globe that is so vital for wellbeing.*

W A B I

No formaldehyde, PVC, softeners, heavy metals or other substances hazardous to health or the environment.

Very low VOC emissions in compliance with GreenGuard GOLD, AgBB scheme and French Classification A+.

Made with 90% of renewable and Recycled by-products of cork.

FSC® certified products are available upon request.





R o s e



W a b i





*Making use of cork's unique and distinct natural aesthetic, MAT is a stylish way to welcome natural finishes to walls. The natural wall tile is available with a coarse textured surface and a range of neutral colours that deliver a premium look in both residential and commercial interiors.*

*The palette of colours allows muted tonal contrasts with other finishes, including natural tones, while connecting the interior to the positive influence of Nature.*

## M A T

For residential and commercial interiors.

Glued installation on walls.

6 colours.

Dimensions: 900 x 300 x 4 mm.

CORKGUARD® waterbased finish with CleanSurface powered by Microban® antimicrobial technology.

No formaldehyde, PVC, softeners, heavy metals or other substances hazardous to health or the environment.

Very low VOC emissions in compliance with GreenGuard GOLD, AgBB scheme and French Classification A+.

Made with 90% of renewable and Recycled by-products of cork.

FSC® certified products are available upon request.

C O N N E C T I N G  
W A L L S  
T O N A T U R E







MAT





A C O L O U R F U L  
N E W M E A N I N G  
T O W A L L S

For residential and commercial interiors.

Glued installation on walls.

15 colours.

Dimensions:

900 x 300 x 5,5 mm and 900 x 150 x 5,5 mm.

Bevelled edges.

AQUADUR waterbased finish with  
CleanSurface powered by Microban®  
antimicrobial technology.

*Designed to bring a colourful new meaning to  
walls, CARIOCA is a striking new cork tile  
concept.*

*With two large tile formats, CARIOCA uses  
bold colour and strong graphic lines on top  
of cork's individual and intrinsic beauty,  
producing a powerful aesthetic that is hard to  
ignore.*

*Bringing a modern graphical edge to cork's  
timeless natural aesthetic, CARIOCA  
expresses the liveliness and energy of cork as  
a contemporary surface material, providing  
a more sustainable alternative to man-made  
surfaces.*

C A R I O C A

No formaldehyde, PVC, softeners, heavy metals  
or other substances hazardous to health or the  
environment.

Very low VOC emissions in compliance with  
GreenGuard GOLD, AgBB scheme and  
French Classification A+.

Made with 90% of renewable and Recycled by-  
products of cork.

FSC® certified products are available upon  
request.





*STORYWALL is a contemporary cork wall coverings collection that inspire glamour, innovation and design.*

*Its inspiration comes from traditional designs of cultures across the globe which are then applied onto cork using traditional industrial techniques and high-tech graphic systems, resulting on a perfect symbiosis between the organic character of cork and digital printed graphics.*

*Without compromising on sustainability, STORYWALL connects commercial and residential interiors to the power of nature in a surprising way.*

## S T O R Y W A L L

For residential and commercial interiors.

Glued installation on walls.

9 digital designs.

Dimensions: 300 x 300 x 4 mm.

CORKGUARD® waterbased finish with CleanSurface powered by Microban® antimicrobial technology.

No formaldehyde, PVC, softeners, heavy metals or other substances hazardous to health or the environment.

Very low VOC emissions in compliance with GreenGuard GOLD, AgBB scheme and French Classification A+.

Made with 90% of renewable and Recycled by-products of cork.

FSC® certified products are available upon request.



W A L L S W I T H A  
S T O R Y





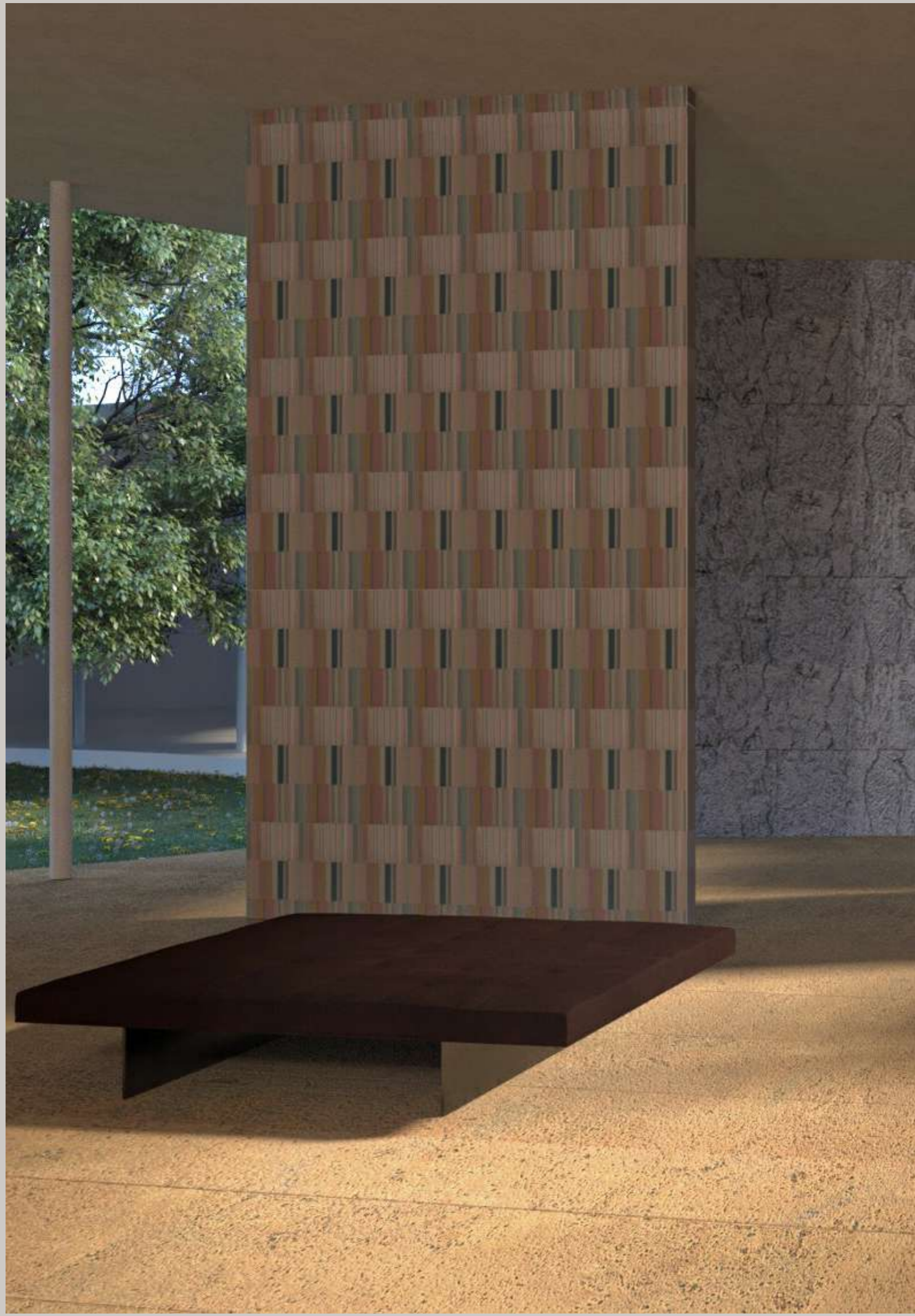

*Using the natural beauty of cork while bringing new meaning to its aesthetic, TATAMI is a wall covering inspired by traditional Japanese tatami rice straw mats.*

*TATAMI minimal design creates its effect through contrasting 3D lines that can be installed in horizontal or vertical arrangements.*

*Bringing subtle depth and texture, the cork tile blends the positive influence of nature with uncomplicated aesthetics to deliver a comfortable, healthy and calming wall finish.*

## T A T A M I

For residential and commercial interiors.

Glued installation on walls.

3 colours.

Dimensions: 600 x 300 x 4 mm.

CORKGUARD® waterbased finish with CleanSurface powered by Microban® antimicrobial technology.

No formaldehyde, PVC, softeners, heavy metals or other substances hazardous to health or the environment.

Very low VOC emissions in compliance with GreenGuard GOLD, AgBB scheme and French Classification A+.

Made with 90% of renewable and Recycled by-products of cork.

FSC® certified products are available upon request.

G R A C E F U L L  
M I N I M A L B U T  
P R O F O U N D  
G E S T U R E S

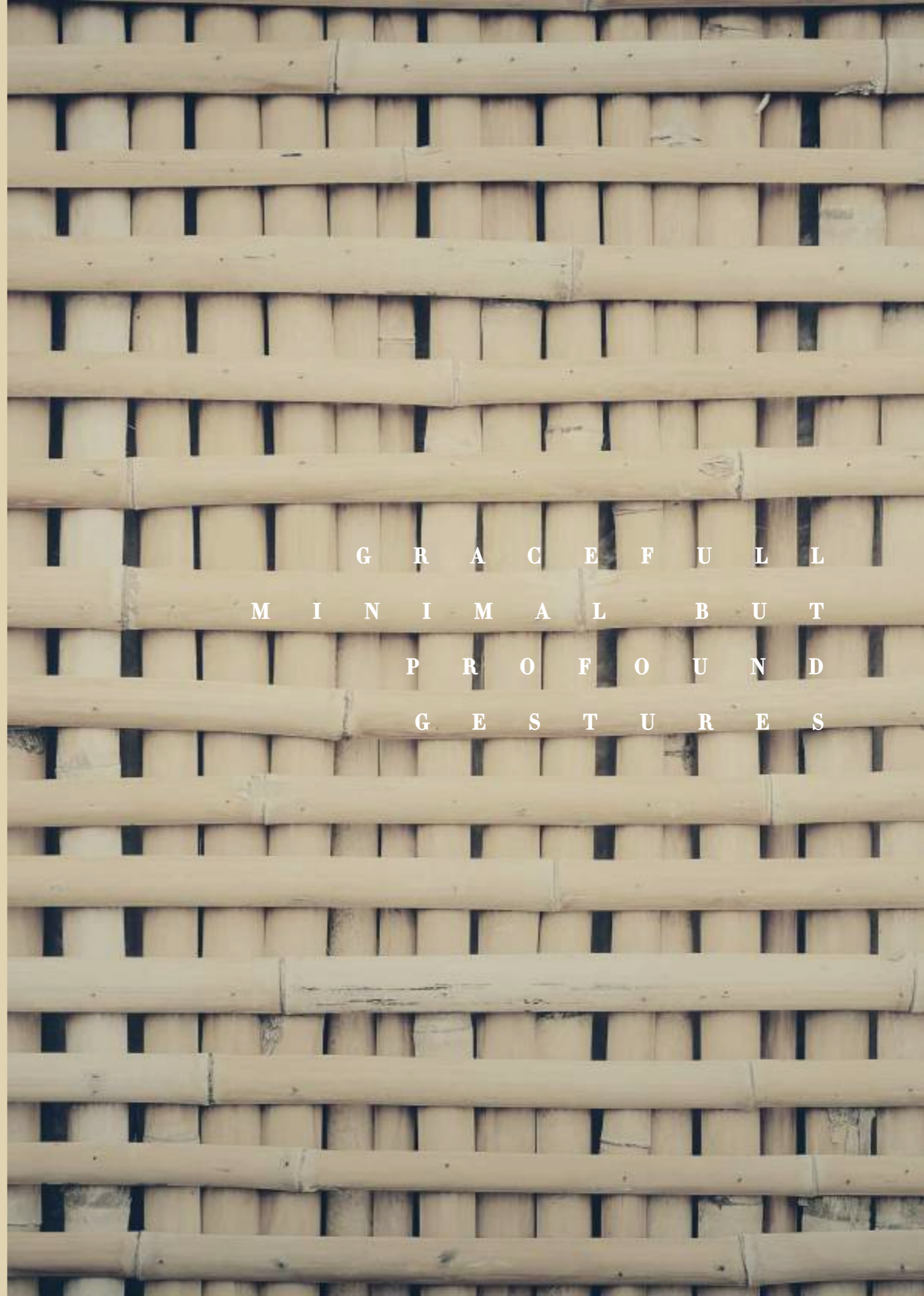

**T a t a m i**  
**L i g h t**







G E T G R O O V Y  
W I T H C O R K

For residential and commercial interiors.

Glued installation on walls.

7 groove colours / 1 toasted cork.

Dimensions: 600 x 300 x 6 mm.

CORKGUARD® waterbased finish with  
CleanSurface powered by Microban®  
antimicrobial technology.

*GROOVY cork wall tiles bring a stylish  
vintage edge to contemporary spaces.*

*Made entirely from post-industrial recycled  
cork, the CNC grooved linear and simple  
design builds a hexagonal motif across the  
wall. GROOVY's air of retro is equally  
balanced by cork's natural aesthetic, for a look  
that feels entirely modern.*

G R O O V Y

No formaldehyde, PVC, softeners, heavy metals  
or other substances hazardous to health or the  
environment.

Very low VOC emissions in compliance with  
GreenGuard GOLD, AgBB scheme and  
French Classification A+.

Made with 90% of renewable and Recycled by-  
products of cork.

FSC® certified products are available upon  
request.

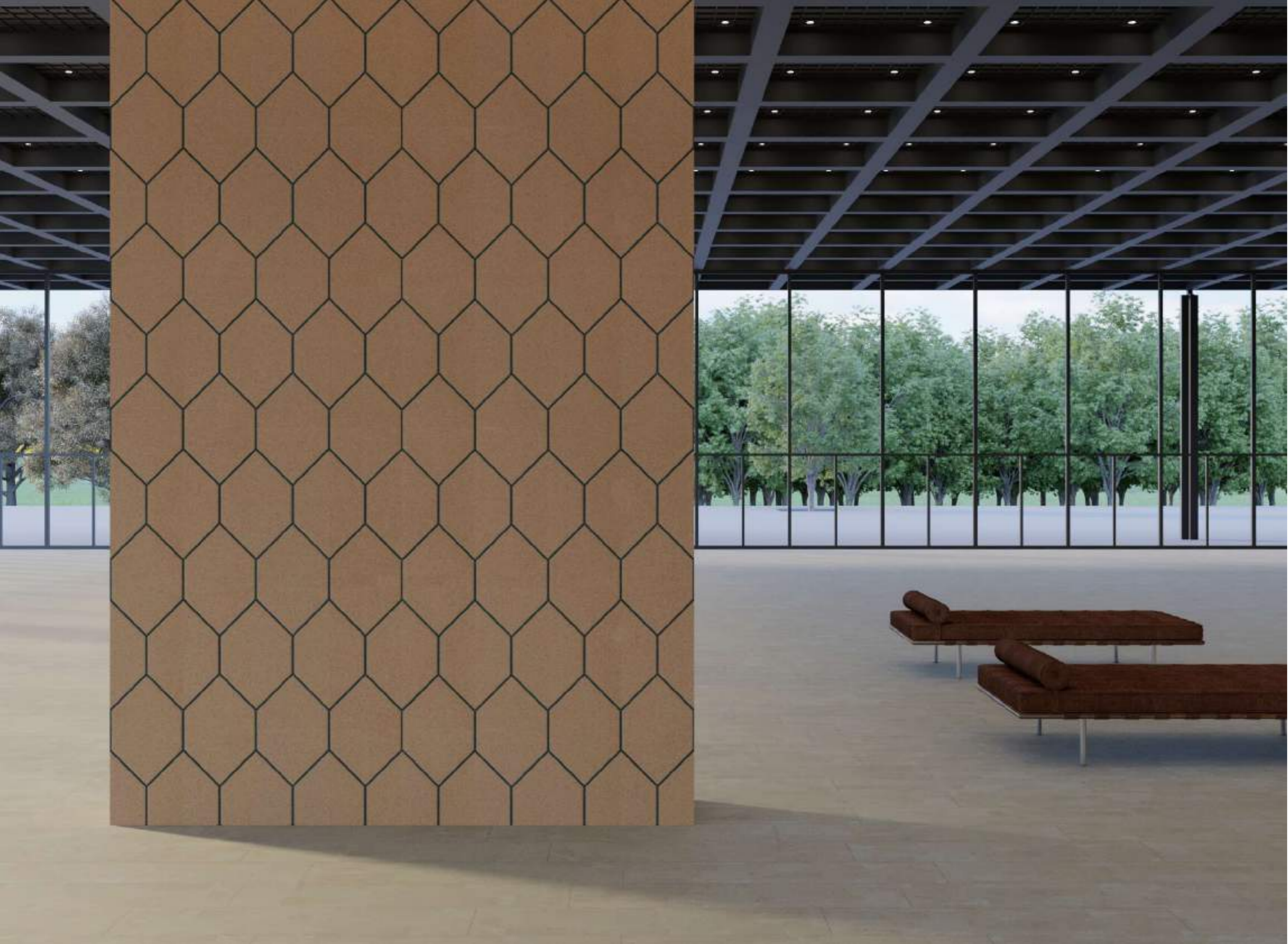



*MODULAR is a proposal of architectural design for interior wall decoration, with 3 basic orthogonal designs with a 3D effect, inspired by the modular compositions of architect Le Corbusier.*

*Installed in combinations and arrangements, the large format cork tiles create an aesthetic that balances the natural expression of cork with the contemporaneity of the design in a fresh and interesting way.*

## M O D U L A R

For residential and commercial interiors.

Glued installation on walls.

4 colours / 1 toasted cork.

Dimensions: 580 x 580 x 7 mm.

CORKGUARD® waterbased finish with CleanSurface powered by Microban® antimicrobial technology.

No formaldehyde, PVC, softeners, heavy metals or other substances hazardous to health or the environment.

Very low VOC emissions in compliance with GreenGuard GOLD, AgBB scheme and French Classification A+.

Made with 90% of renewable and Recycled by-products of cork.

FSC® certified products are available upon request.

T H E B E A U T Y  
O F L I N E S  
A N D C O L O U R





M o d u l a r





S P A C E , L I G H T  
A N D O R D E R

For residential and commercial interiors.

Glued installation on walls.

Natural toasted cork texture.

Format: 900 x 300 and 900 x 150 mm.

Thickness: 3, 6 and 9 mm.

CORKGUARD® waterbased finish with  
CleanSurface powered by Microban®  
antimicrobial technology.

*BEBOP is a statement cork tile that brings  
geometric 3D patterns to interiors, a natural  
and sustainable way to create high-impact  
walls.*

*Made from agglomerated toasted cork grains,  
BEBOP comes in a distinctive deep dark  
brown that shows cork's natural aesthetic and,  
by using the different size and thickness of tile  
across the wall, it creates a geometric pattern  
forming intense dark shadows.*

B E B O P

No formaldehyde, PVC, softeners, heavy metals  
or other substances hazardous to health or the  
environment.

Very low VOC emissions in compliance with  
GreenGuard GOLD, AgBB scheme and  
French Classification A+.

Made with 90% of renewable and Recycled by-  
products of cork.

FSC® certified products are available upon  
request.







A S C U L P T U R A L  
W A Y T O C O N N E C T  
W I T H N A T U R E

For residential and commercial interiors.

Glued installation on walls.

3 shapes, 5 colours.

Dimensions:

300 x 300 x 30 mm and 150 x 150 x 30 mm.

CORKGUARD® waterbased finish with

CleanSurface powered by Microban®  
antimicrobial technology.

*3DFORMS takes inspiration from Portuguese tiles and wood panelling of the 1950s and 1960s, creating striking geometric pattern across the wall. Relying on the tonal contrast between shadows and highlights, 3DFORMS has a sculptural quality that changes emphasis as light changes throughout the course of day and night.*

*3DFORMS delivers a striking alternative aesthetic to ceramic wall tiles. From simply rotating designs to create subtly changing, rhythmic repeating patterns to unique combinations made up of any of the three forms in any size, it is a playful way to welcome the cork look, creating a protecting and comfortable feel that brings us closer to nature.*

3 D F O R M S

No formaldehyde, PVC, softeners, heavy metals or other substances hazardous to health or the environment.

Very low VOC emissions in compliance with GreenGuard GOLD, AgBB scheme and French Classification A+.

Made with 90% of renewable and Recycled by-products of cork.

FSC® certified products are available upon request.



3DFORMIS Pearl Porto combination

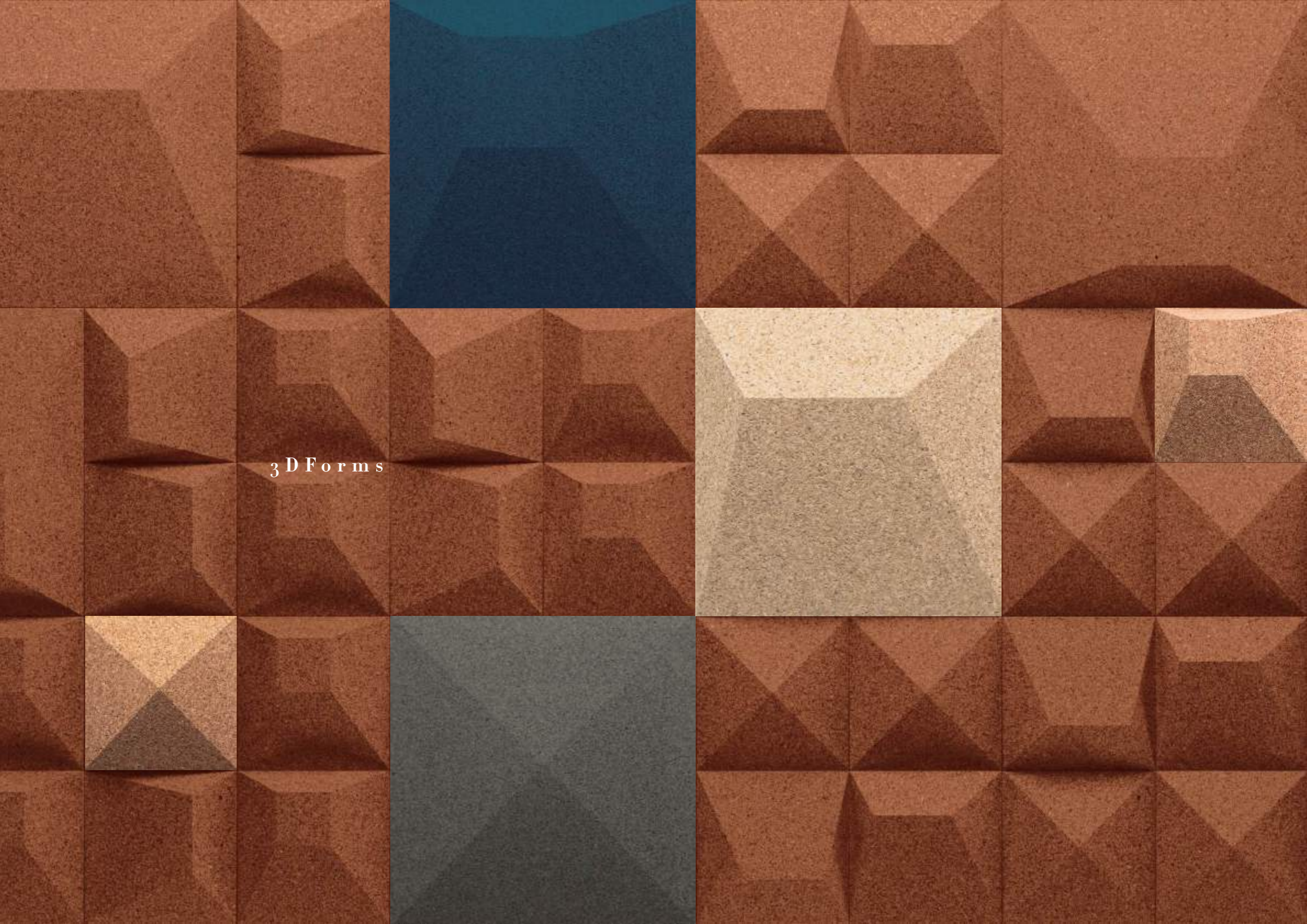

3 D F o r m s



*Showing cork in its truest, most expressive and organic form, RUSTICORK creates statement walls with unique effects, impossible to mimic. Using raw bark and natural cork RUSTICORK not only delivers an unmistakable natural aesthetic, but also a wall that helps to control airborne noise and retain heat. Natural, biodegradable and recyclable, RUSTICORK stands out for aesthetics, function and its renewable natural status.*

## R U S T I C O R K

For residential and commercial interiors.

Glued installation on walls.

3 textures, 6 colours.

Format:

900 x 600 mm and 600 x 300 mm.

Natural or waterbased paint.

No formaldehyde, PVC, softeners, heavy metals or other substances hazardous to health or the environment.

Very low VOC emissions in compliance with GreenGuard GOLD, AgBB scheme and French Classification A+.

Made with 90% of renewable cork.

FSC® certified products are available upon request.

## W A L L S T H A T W O W





RUSTICORK Sandstone Warm White





DELIVERING NATURE

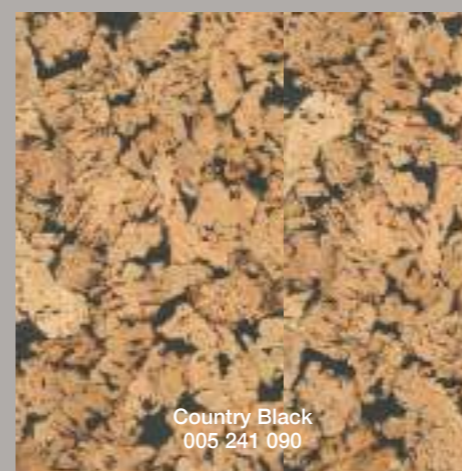
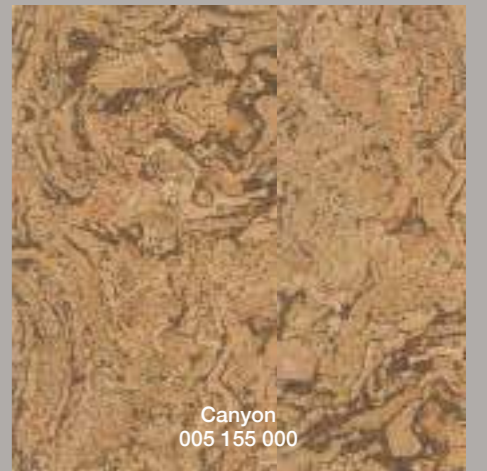
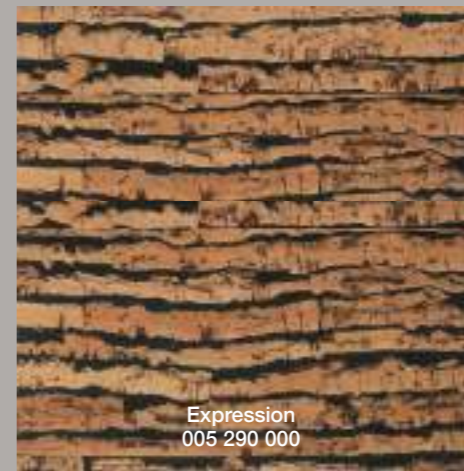
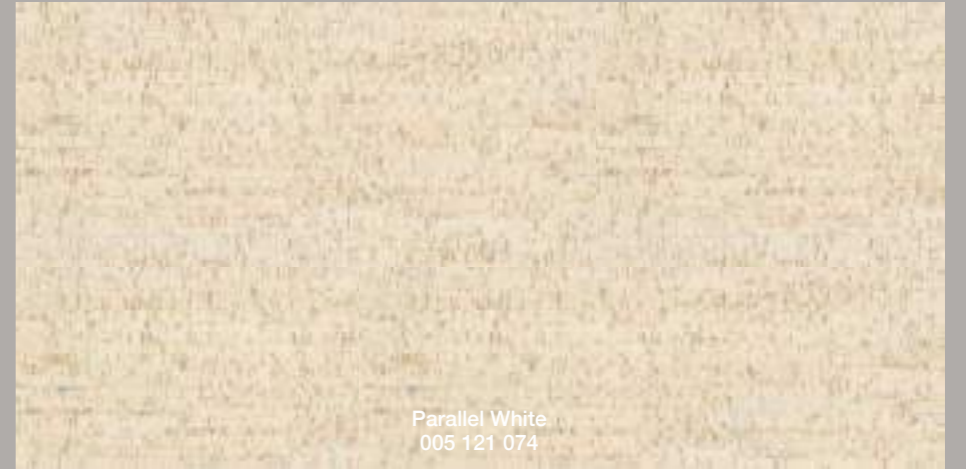

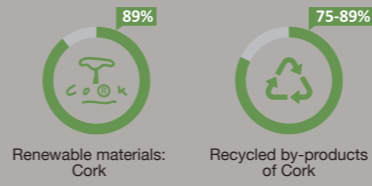

- 1 PARAWAX matt finish
- 2 Natural cork decorative veneer
- 3 Agglomerated cork backing

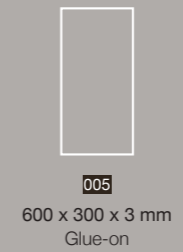

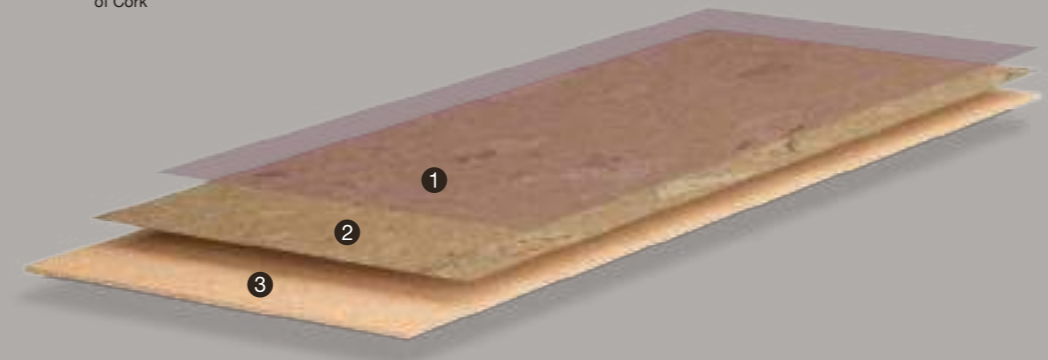
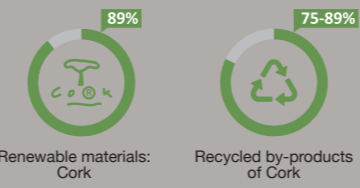

- 1 CORKGUARD® waterbased protection with CleanSurface technology
- 2 Natural cork decorative veneer
- 3 Agglomerated cork backing

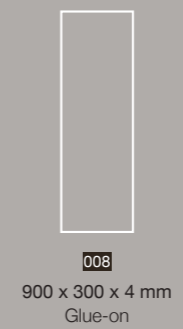

FSC® certified products are available upon request.

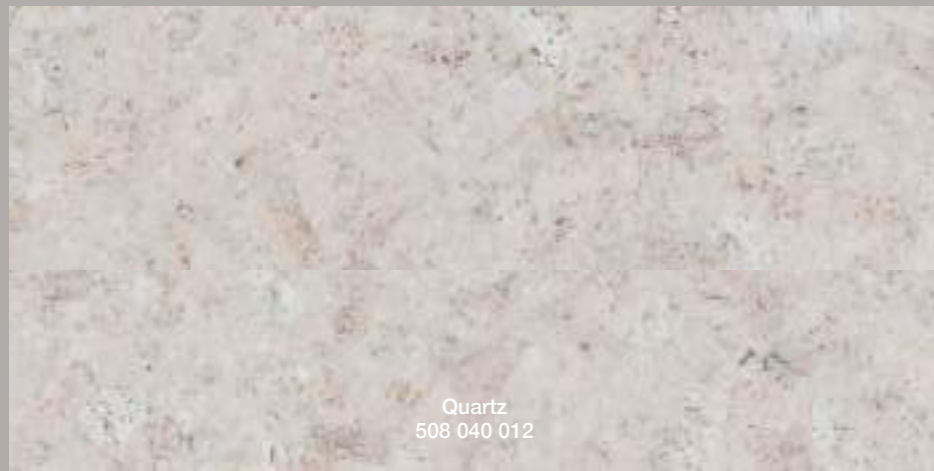

Renewable materials:  
Cork

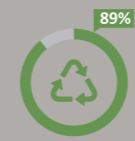

Recycled by-products  
of Cork



- 1 CORKGUARD® waterbased protection with CleanSurface technology
- 2 Rough natural cork decorative veneer
- 3 Agglomerated cork backing



508  
900 x 300 x 4 mm  
Glue-on



FSC® certified products are available upon request.



Combinations

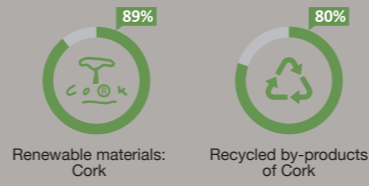
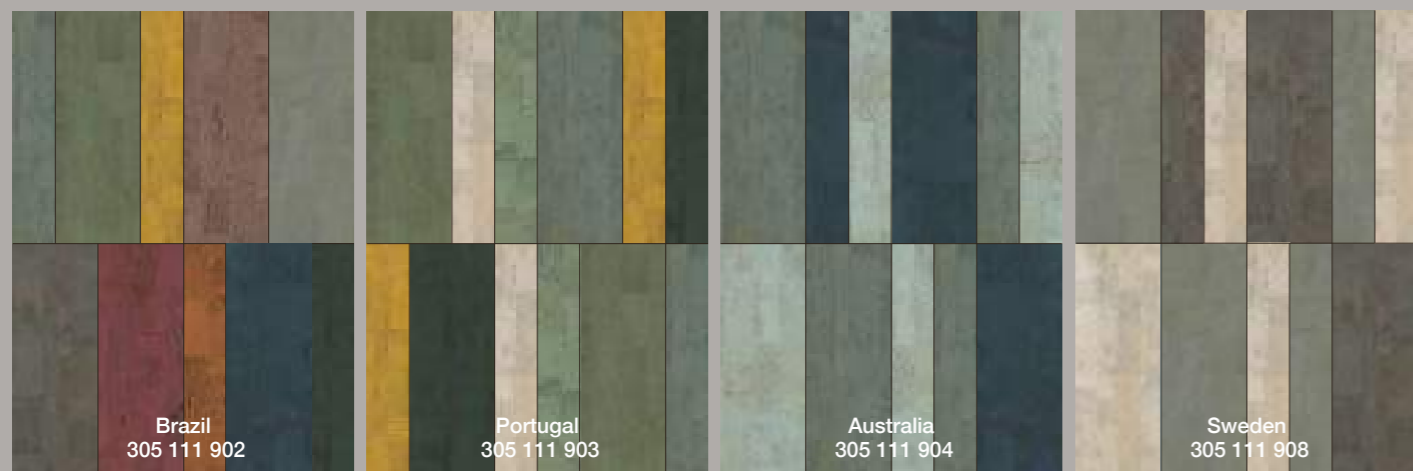

- 1 AQUADUR waterbased matt finish with CleanSurface technology
- 2 Natural cork decorative veneer
- 3 Bevelled edges
- 4 Expanded black agglomerated cork backing

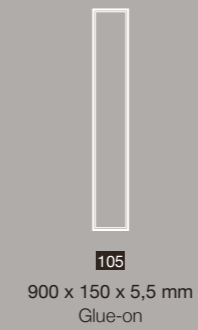
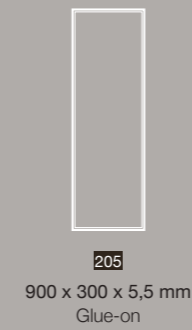

FSC® certified products are available upon request.

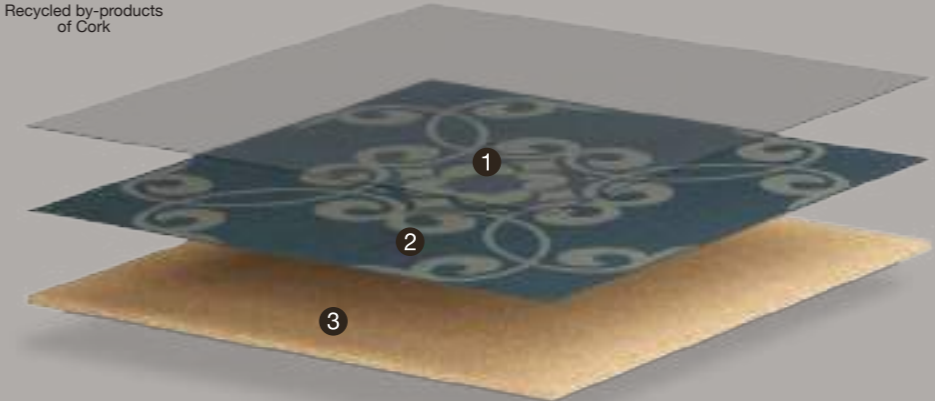
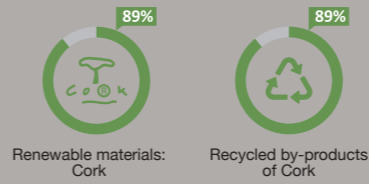

- 1 CORKGUARD® waterbased protection with CleanSurface technology
- 2 High Definition Digital Printing
- 3 Agglomerated cork



101  
300x 300 x 4 mm  
Glue-on

Combinations



FSC® certified products are available upon request.



Tatami Natural  
316 023 000

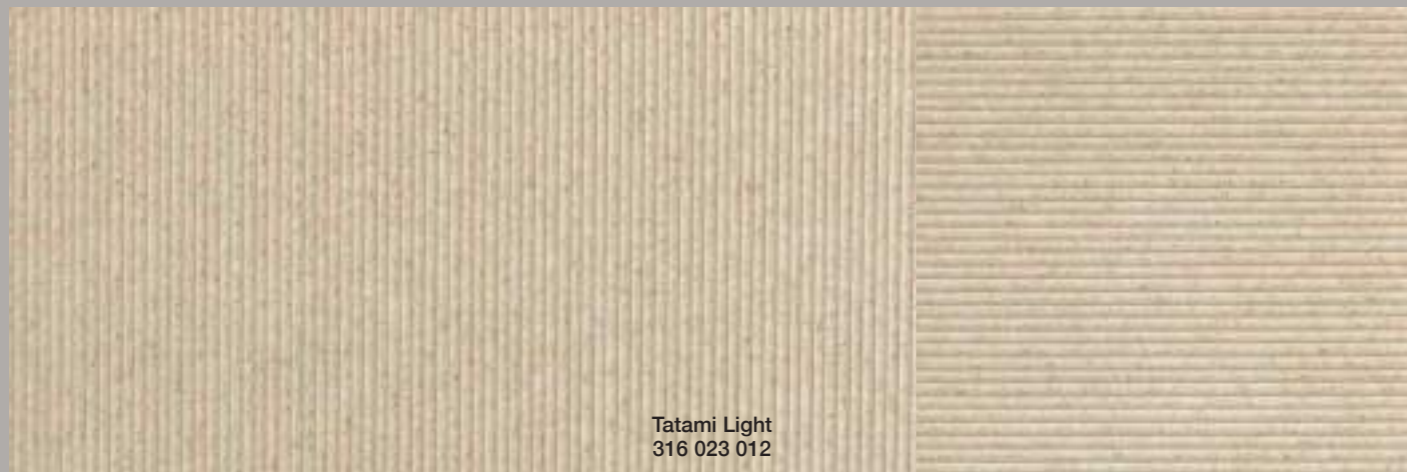

Tatami Light  
316 023 012



Tatami Midnight  
316 310 000

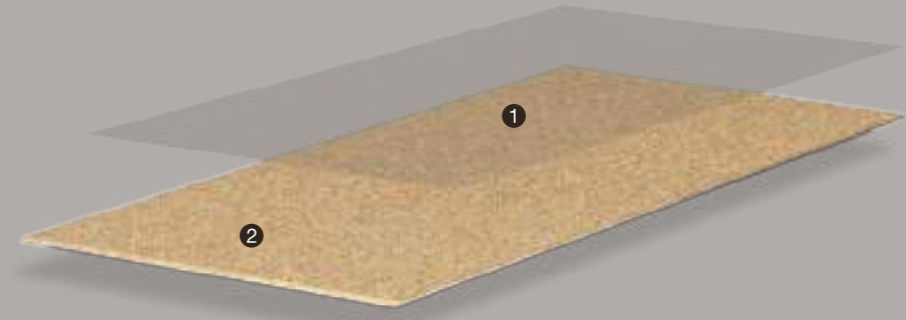
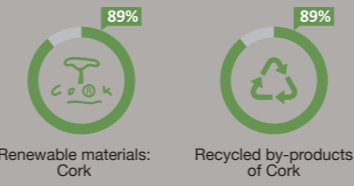

- 1 CORKGUARD® waterbased protection with CleanSurface technology
- 2 Pressed texture agglomerated cork

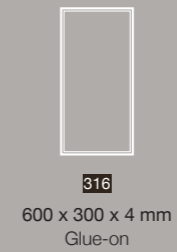

FSC® certified products are available upon request.

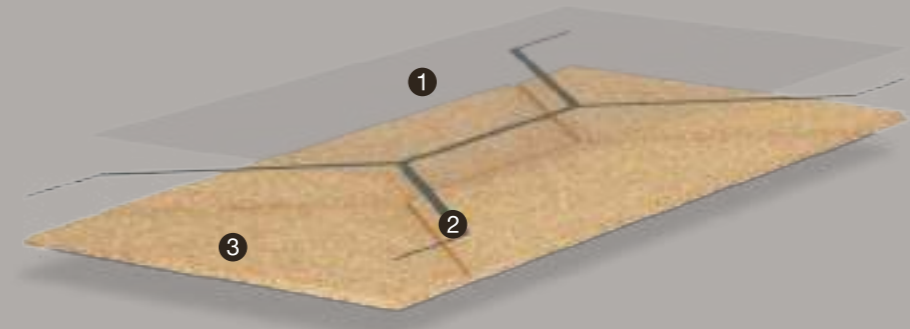
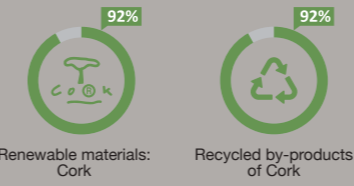

- 1 CORKGUARD® waterbased protection with CleanSurface technology
- 2 Printed colour
- 3 CNC machined agglomerated cork



315  
600 x 300 x 6 mm  
Glue-on

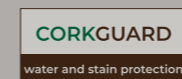
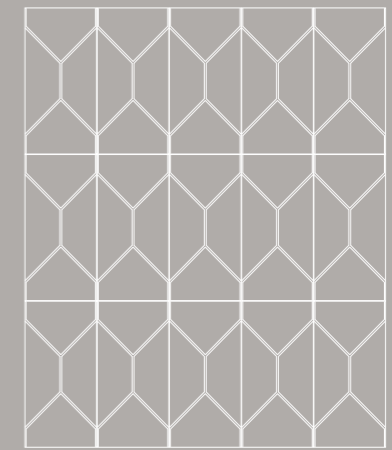

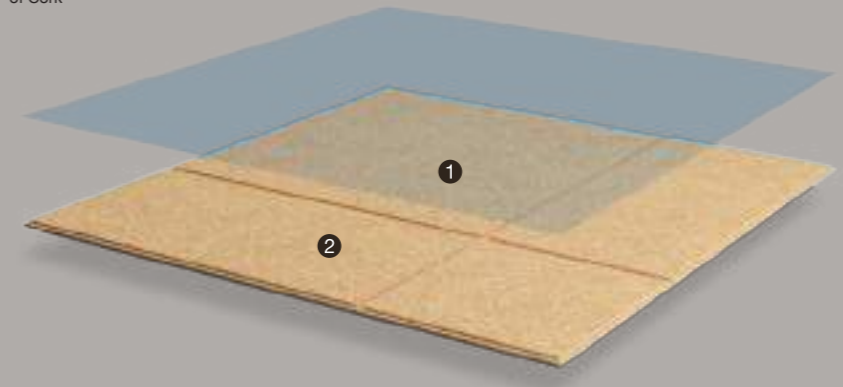
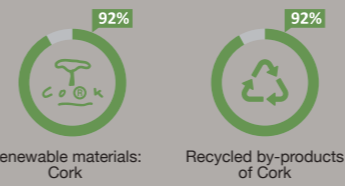
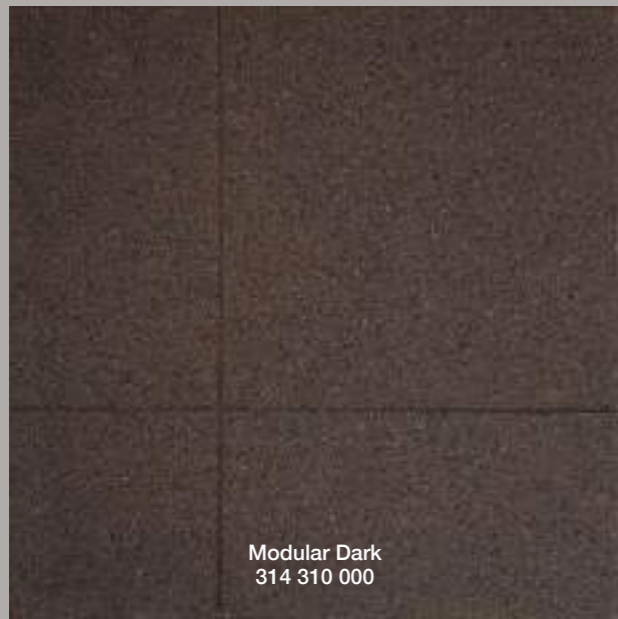

1 CORKGUARD® waterbased protection with CleanSurface technology 2 CNC machined agglomerated cork

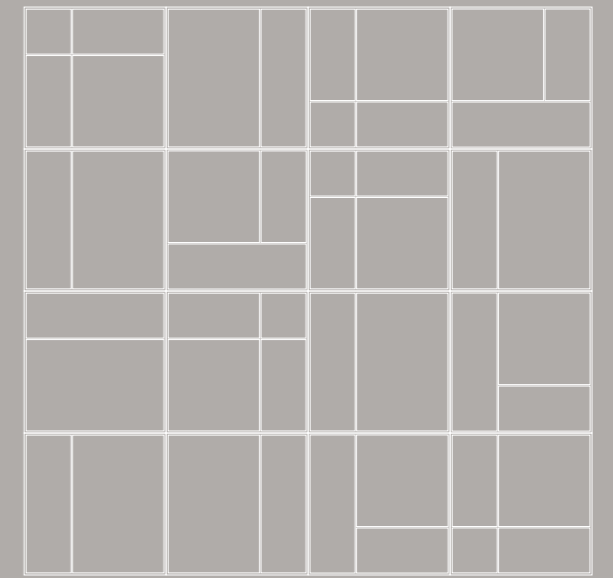
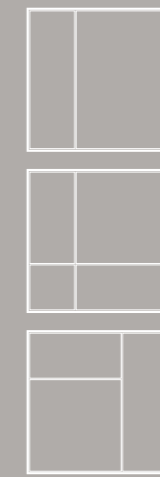

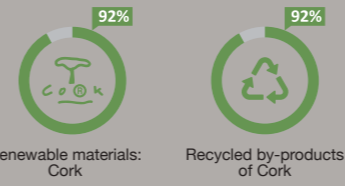

1 CORKGUARD® waterbased protection with CleanSurface technology 2 Expanded black agglomerated cork



312

- 900 x 300 x 3 mm
- 900 x 300 x 6 mm
- 900 x 150 x 6 mm
- 900 x 150 x 9 mm
- Glue-on

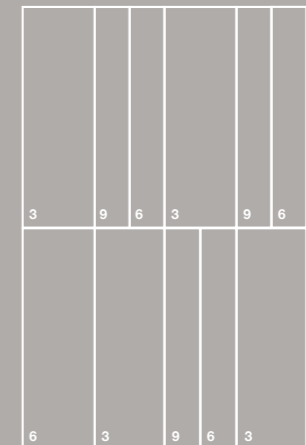

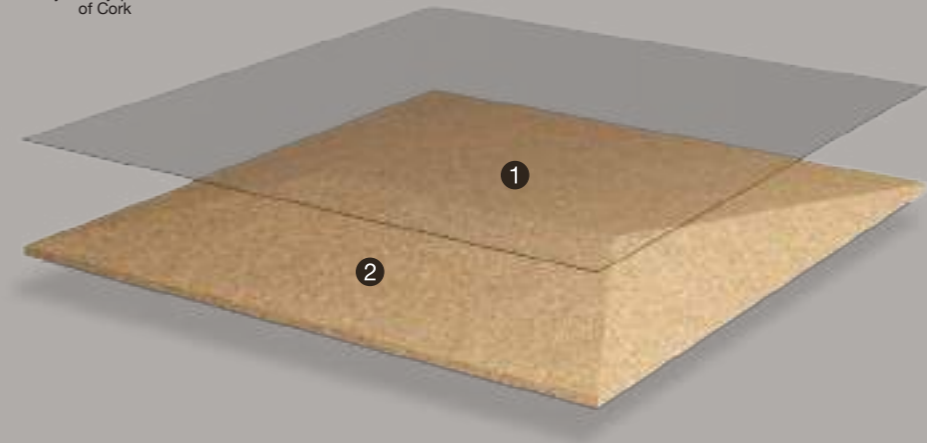
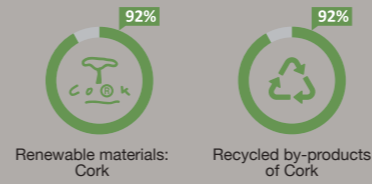
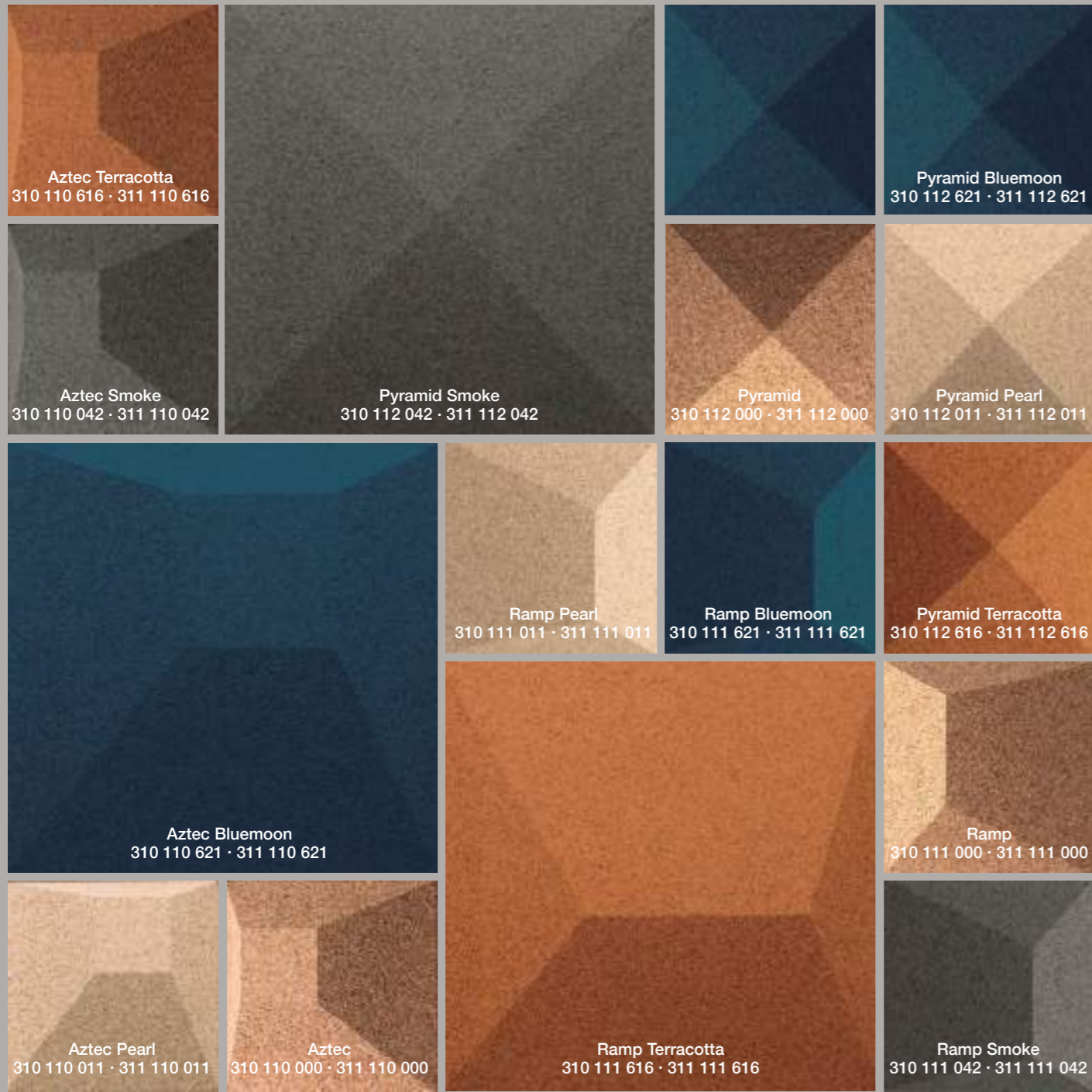

1 CORKGUARD® waterbased protection protection with CleanSurface technology 2 CNC machined agglomerated cork



Combinations



Lisboa  
313 310 (000 / 011 / 042 / 616 / 621)

Porto  
313 311 (000 / 011 / 042 / 616 / 621)

Douro  
313 312 (000 / 011 / 042 / 616 / 621)



FSC® certified products are available upon request.



Bark  
006 070 000 · 906 070 000



Bark Bluemoon  
006 070 614 · 906 070 614

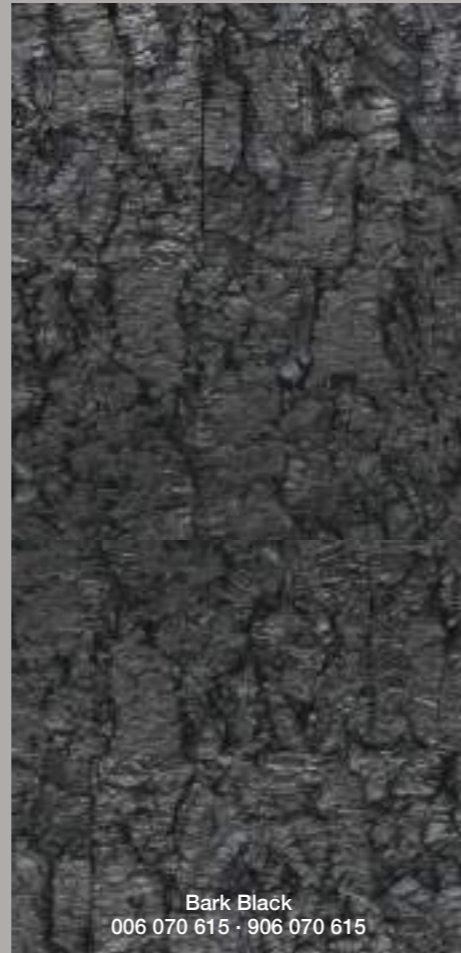

Bark Black  
006 070 615 · 906 070 615



Sandstone  
006 071 000 · 906 071 000



Sandstone Warm White  
006 071 019 · 906 071 019



Slate  
006 074 000 · 906 074 000



Slate Ash Grey  
006 074 048 · 906 074 048



Slate Terracotta  
006 074 616 · 906 074 616

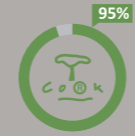

Renewable materials:  
Cork



- 1 Rough cork bark or natural cork
- 2 Agglomerated cork backing (Sandstone and Bark)

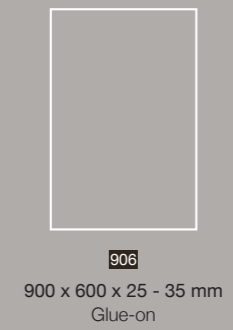
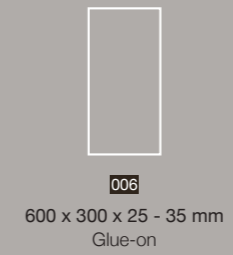

FSC® certified products are available upon request.

# Technical data

|   |                 |                | Decodalle               | Wabi/Mat                          | Carioca                           | Storywall                         | Tatami                            | Groovy                            | Modular                           | Bebop                             | 3DForms                           | Rusticork                         |
|---|-----------------|----------------|-------------------------|-----------------------------------|-----------------------------------|-----------------------------------|-----------------------------------|-----------------------------------|-----------------------------------|-----------------------------------|-----------------------------------|-----------------------------------|
| Finish  |                 |                | PARAWAX                 | CORKGUARD®                        | AQUADUR                           | CORKGUARD®                        | CORKGUARD®                        | CORKGUARD®                        | CORKGUARD®                        | CORKGUARD®                        | CORKGUARD®                        | Natural/Painted                   |
| Installation system                           |                 |                | Glue-on                 | Glue-on                           | Glue-on                           | Glue-on                           | Glue-on                           | Glue-on                           | Glue-on                           | Glue-on                           | Glue-on                           | Glue-on                           |
| <b>General Properties</b>                     | <b>Standard</b> | <b>Unit</b>    |                         |                                   |                                   |                                   |                                   |                                   |                                   |                                   |                                   |                                   |
| Dimensions                                    | EN ISO 24342    | mm             | 600x300 ± 0,5%          | 900x300 ± 0,5%                    | 900x150 ± 0,5%<br>900x300 ± 0,5%  | 300x300 ± 0,5%                    | 600x300 ± 0,5%                    | 600x300 ± 0,5%                    | 580x580 ± 0,5%                    | 900x150 ± 0,5%<br>900x300 ± 0,5%  | 150x150 ± 0,5%<br>300x300 ± 0,5%  | 600x300<br>900x600                |
| Thickness                                     | ISO 7322        | mm             | 3 ± 0,2                 | 4 ± 0,2                           | 5,5 ± 0,2                         | 4 ± 0,2                           | 4 ± 0,2                           | 6 ± 0,2                           | 7 ± 0,2                           | 3 / 6 / 9 ± 0,2                   | 30 ± 0,5                          | 25 - 35                           |
| Squareness                                    | EN ISO 24342    | mm             | < 0,4                   | < 0,4                             | < 0,4                             | < 0,4                             | < 0,4                             | < 0,4                             | < 0,4                             | < 0,4                             | < 0,4                             | < 1                               |
| Straightness                                  | EN ISO 24342    | mm             | < 0,3                   | < 0,3                             | < 0,3                             | < 0,3                             | < 0,3                             | < 0,3                             | < 0,3                             | < 0,3                             | < 0,3                             | < 1                               |
| Apparent density                              | ISO 7322        | Kg/m³          | 290                     | 300                               | 310                               | 330                               | 330                               | 290                               | 290                               | 300                               | 200                               |                                   |
| Mass per unit area                            | EN ISO 23997    | g/m²           | 870 ± 10%               | 1200 ± 10%                        | 1700 ± 10%                        | 1300 ± 10%                        | 1300 ± 10%                        | 1740 ± 10%                        | 2000 ± 10%                        | 1800 (av)                         | 3170 (av)                         | 5000 - 7500                       |
| Compression                                   | ISO 7322        | %              | ≤ 40                    | ≤ 40                              | ≤ 40                              | ≤ 40                              | ≤ 40                              | ≤ 40                              | ≤ 40                              | ≤ 40                              | ≤ 40                              |                                   |
| Recuperation                                  | ISO 7322        | %              | ≥ 75                    | ≥ 75                              | ≥ 80                              | ≥ 80                              | ≥ 80                              | ≥ 80                              | ≥ 80                              | ≥ 80                              | ≥ 80                              |                                   |
| Dimensional stability                         | ISO 23999       | %              | < 0,4                   | < 0,4                             | < 0,4                             | < 0,4                             | < 0,4                             | < 0,4                             | < 0,4                             | < 0,4                             | < 0,4                             |                                   |
| Moisture Content                              | EN 12105        | %              | ≤ 8                     | ≤ 8                               | ≤ 8                               | ≤ 8                               | ≤ 8                               | ≤ 8                               | ≤ 8                               | ≤ 8                               | ≤ 8                               | ≤ 10                              |
| Curling                                       | EN ISO 23999    | mm             | < 6                     | < 6                               | < 6                               | < 6                               | < 6                               | < 6                               | < 6                               | < 6                               | < 6                               |                                   |
| Tensile strength                              | ISO 7322        | kPa            | ≥ 700                   | ≥ 700                             | ≥ 1000                            | ≥ 1000                            | ≥ 1000                            | ≥ 1000                            | ≥ 1000                            | ≥ 700                             | ≥ 700                             |                                   |
| <b>Safety Properties</b>                      | <b>Standard</b> | <b>Unit</b>    |                         |                                   |                                   |                                   |                                   |                                   |                                   |                                   |                                   |                                   |
| Reaction to fire                              | EN 13501-1      | Class          | E                       | E                                 | E                                 | E                                 | E                                 | E                                 | E                                 | E                                 | E                                 | E                                 |
| Formaldehyde emission                         | EN 12149        | mg/Kg          | Passed                  | Passed                            | Passed                            | Passed                            | Passed                            | Passed                            | Passed                            | Passed                            | Passed                            | Passed                            |
| Vinyl Chloride Monomer (VCM)                  | EN 12149        | mg/Kg          | Passed                  | Passed                            | Passed                            | Passed                            | Passed                            | Passed                            | Passed                            | Passed                            | Passed                            | Passed                            |
| Release of heavy metals and specific elements | EN 12149        | mg/Kg          | Passed                  | Passed                            | Passed                            | Passed                            | Passed                            | Passed                            | Passed                            | Passed                            | Passed                            | Passed                            |
| <b>Additional Properties</b>                  | <b>Standard</b> | <b>Unit</b>    |                         |                                   |                                   |                                   |                                   |                                   |                                   |                                   |                                   |                                   |
| Thermal resistance                            | EN 12667        | m².K/W         | 0,06                    | 0,09                              | 0,11                              | 0,09                              | 0,09                              | 0,12                              | 0,14                              | 0,12                              | 0,61                              | 0,49                              |
| Thermal conductivity                          | EN 12667        | W/m.K          | 0,05                    | 0,05                              | 0,05                              | 0,05                              | 0,05                              | 0,05                              | 0,05                              | 0,05                              | 0,05                              | 0,05                              |
| Weighted sound absorption coefficient         | EN ISO 354      | α <sub>w</sub> | 0,05                    | 0,1                               | 0,1                               | 0,1                               | 0,1                               | 0,05                              | 0,05                              | 0,1                               | 0,1                               | 0,25                              |
| <b>Other Features</b>                         |                 |                |                         |                                   |                                   |                                   |                                   |                                   |                                   |                                   |                                   |                                   |
| FSC® certification                            |                 |                | Available on request    | Available on request              | Available on request              | Available on request              | Available on request              | Available on request              | Available on request              | Available on request              | Available on request              | Available on request              |
| Antimicrobial protection                      |                 |                |                         | CleanSurface Powered by Microban® | CleanSurface Powered by Microban® | CleanSurface Powered by Microban® | CleanSurface Powered by Microban® | CleanSurface Powered by Microban® | CleanSurface Powered by Microban® | CleanSurface Powered by Microban® | CleanSurface Powered by Microban® | CleanSurface Powered by Microban® |
| VOC Emission Certifications                   |                 |                | Greenguard Gold AgBB A+ | Greenguard Gold AgBB A+           | Greenguard Gold AgBB A+           | Greenguard Gold AgBB A+           | Greenguard Gold AgBB A+           | Greenguard Gold AgBB A+           | Greenguard Gold AgBB A+           | Greenguard Gold AgBB A+           | Greenguard Gold AgBB A+           | Greenguard Gold AgBB A+           |
| m² per carton (pieces)                        |                 | m² (un)        | 15,84 m² (88)           | 5,94 m² (22)                      | 4,32 m² (32/16)                   | 7,92 m² (88)                      | 7,92 m² (44)                      | 7,92 m² (44)                      | 7,06 m² (21)                      | 4,59 m² (23)                      | 1,62 m² (72/18)                   | 4,32 m² (24/8)                    |
| m² per pallet (cartons)                       |                 | m² (un)        | 665,3 m² (42)           | 332,6 m² (56)                     | 241,9 m² (56)                     | 427,7 m² (54)                     | 427,7 m² (54)                     | 332,6 m² (42)                     | 169,5 m² (24)                     | 257 m² (56)                       | 68 m² (42)                        | 60,5 m² (14)                      |
| Weight of carton                              |                 | Kg             | 12                      | 7                                 | 9                                 | 11                                | 11                                | 14                                | 14                                | 9                                 | 6                                 | 30                                |



Aqueous dispersion based on SCOTCHGARD™ and a combination of resins, designed to provide excellent water, oil and stain repellent properties on natural cork.

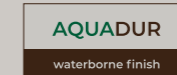

Very low emissions waterborne finish, with a natural look-and-feel, great elasticity and good chemical resistance.



Wax based product developed specially for cork, with good flexibility, abrasion, and moisture/water repellence.



4 sides beveling edges for aesthetic enhancement.



Direct-to-cork digital print proprietary technology.



Formaldehyde-free, PVC-free and phthalates-free cork agglomeration technology.



Integrated antibacterial protection in the surface finish, thanks to exclusive Microban® technology.



Certification assuring that strict indoor air emissions limits are met.



FSC® C044061 Certified chain-of-custody system, meeting the requirements of Forest Stewardship Council® standards.



International symbol identifying products made with genuine cork.

## Walls maintenance

Delivering Nature wall tiles are finish with a special coating that will keep their beautiful look for many years. However, as any other kind of wall covering, it requires a proper cleaning to ensure durability and appearance. As time passes, wall tiles may, eventually, need some kind of maintenance. Although we can make general recommendations, the specific use conditions will determine how frequent maintenance is needed.

Periodic maintenance for wallcoverings should include light dusting or use of a vacuum cleaner with a soft brush attachment. Stains should be removed as soon as possible to limit possible reaction between the staining agent and the wallcovering. Time is especially important for removing materials containing colours or solvents, such as ballpoint ink, lipstick, oil, shampoo tints, and some foodstuff. Remove any damp or wet marks as much as possible using an absorbent material. Remove any dry marks or dirt using a slightly damp cloth, mild soap, warm water, and if necessary, a soft brush to remove dirt from the crevices of deeply textured patterns. For more difficult stains, the use of a standard non-aggressive cleaning agent is recommended. Only mist the wall lightly with the cleaning solution or spray the cleaner directly onto a clean sponge or cloth. Avoid excess rubbing.

## Attention

Delivering Nature products are made with high quality natural materials and should be handled accordingly. In spite of all due care given during manufacturing, there will be variations in appearance (colour, gloss, or texture). This should be verified before installation, distributing the tiles in a way that variations are not striking. The surface may change colour when exposed to direct sunlight.

Although every effort has been made to ensure accuracy during the production of this catalogue, GRANORTE disclaims potential product changes and possible print errors. The product photos may not accurately match the real colour and texture of the finished product.

# GRANORTE



GRANORTE - Revestimentos de Cortiça, Lda.  
Avenida Santiago, 68 | 4520-470 Rio Meão | PORTUGAL  
info@granorte.pt | www.granorte.pt

GRANORTE UK LTD  
Unit 18 Cedar Court | Halesfield 17 | Telford TF7 4PF | UK  
info@granorte.co.uk | www.granorte.co.uk

GRANORTE GmbH DEUTSCHLAND  
Nimrodstraße 22 | 90441 Nürnberg | GERMANY  
info@granorte.de | www.granorte.de

VANETON Srl a unico socio  
Via Repubblica di San Marino, 38 | 41123 Modena | ITALIA  
info@granorte.it | www.granorte.it

Shanghai Parquet Cork Import & Export Co., Ltd.  
No. 667 Long Ziwei Rd. | Building 135, Room 201  
Pudong Dist. Shanghai 201210 | CHINA



