

# CHART 1.2/1.6 & CHART ASYM 1.2/1.6

INSTALLATION INSTRUCTIONS | NOVEMBER 2022

with ground housing

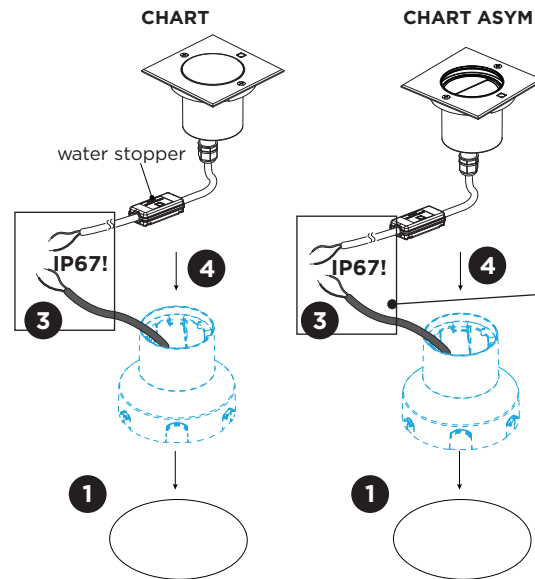

**Do not cut off or open the water stopper on the cable.**

## Included:

waterproof connectors:



## Optional:

IP68 connection box:

order ref. 73240706 = 2 WAYS 2x1,5 Ø6-8mm

Cut an opening in the ground housing to easier guide the cable sideways.

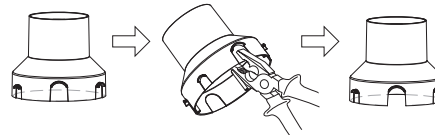

## DIMENSIONS

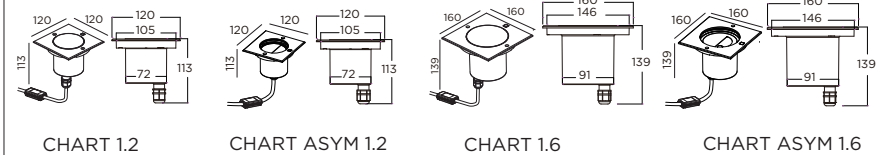

## MOUNTING INSTRUCTION WITH GROUND HOUSING

- 1 Make a hole in the ground according to the prescribed dimensions (of the ground housing).
- 2 Drainage: we recommend that all exterior groundspots should be installed with a drainage level even when using a recessed housing.

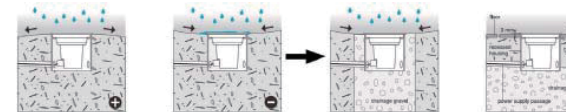

## POWER CONNECTION

- 3 Connect to 220-240V.
- 4 Use screws to attach the fixture to the ground housing, screws are included.

## optional ground housing

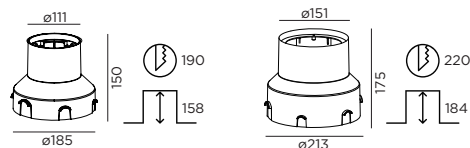

90012203  
for CHART 1.2  
for CHART ASYM 1.2

90012204  
for CHART 1.6  
for CHART ASYM 1.6



**WEVER & DUCRÉ**  
LIGHTING

**WEVER & DUCRÉ BV**  
Spinnerijstraat 99/21, 8500 Kortrijk, Belgium  
weverducre.com

PB19-010-773-00\_v2

# CHART 1.2/1.6 & CHART ASYM 1.2/1.6

INSTALLATION INSTRUCTIONS | NOVEMBER 2022

## without ground housing

A. Attached to the floor (or wall, for wall mounting).

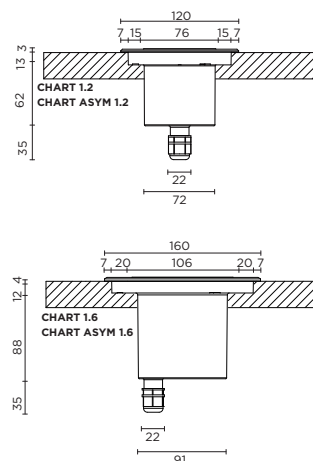
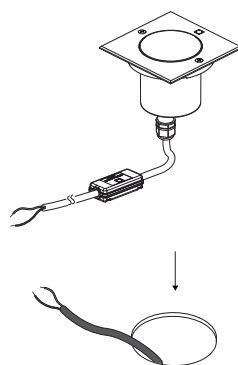

B. Rests on the stainless steel borders of the fixture.

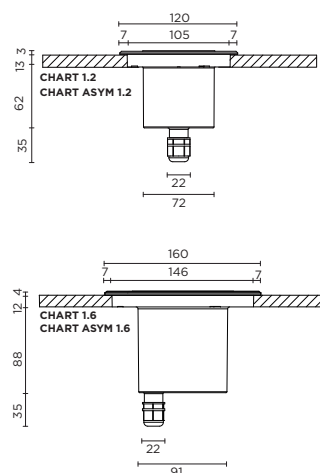
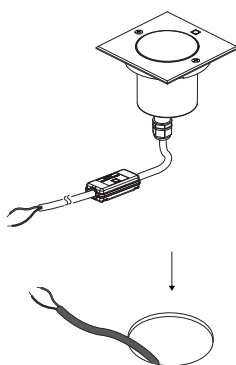

## MOUNTING INSTRUCTION WITHOUT GROUND HOUSING

A. Attached to the floor (or wall, for wall mounting).

- 4 Use the screws (included) to attach the luminaire to the floor or wall. Make sure to measure correctly so that you can screw into a hard material.

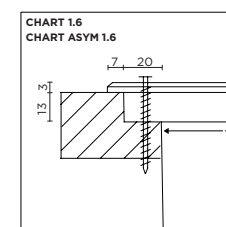
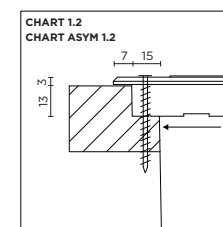

B. Rests on the stainless steel borders of the fixture.

- 4 Place the luminaire into the hole. No tool is needed to fix the luminaire as it will rest on the stainless steel frame.

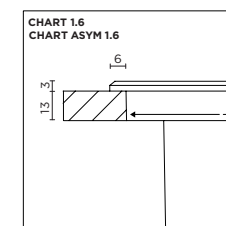
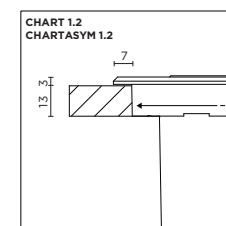

Note:  
the bolts and  
nuts can be used  
for filling the  
screwholes.

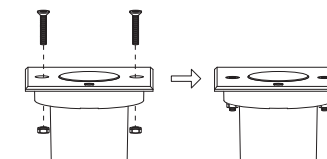

# CHART 1.2/1.6 & CHART ASYM 1.2/1.6

INSTALLATION INSTRUCTIONS | NOVEMBER 2022

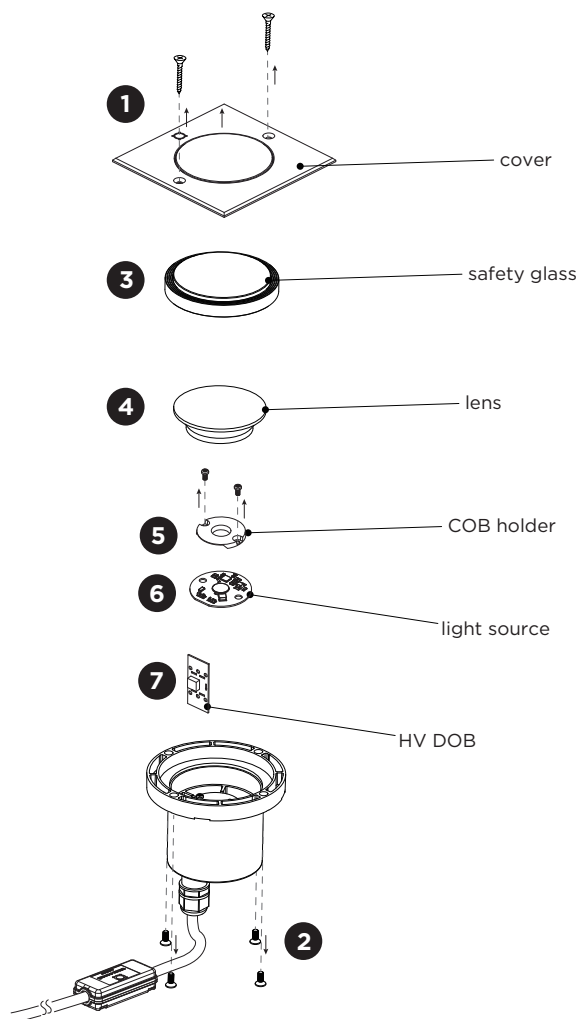

## DISMOUNTING AND RECYCLING INSTRUCTIONS

### Light source

- 1 Remove the screws and take out the fixture.
- 2 Remove the four screws below and remove the cover.
- 3 Remove the safety glass.
- 4 Remove the lens.
- 5 Remove the screws and the COB holder.
- 6 Disconnect the wires and remove the light source.
- 7 Remove the HV DOB.



The light source is replaceable by an authorized professional.  
For advice contact your Wever & Ducré customer service contact point.



This luminaire contains a light source with the energy class F.