

THE

NATIVIA

CUTT



NATIVIA









Nativia features an island with a powerful monolithic concept, a central channel, a sink with a built-in ceramic basin and hobs fastened to the countertop.

Welcome to a new era of living, where sharp separation of spaces is replaced by a perfect integration of environments, and your kitchen is no longer just a place where food is prepared but it plays a vital role in creating relationships and promoting experimentation.

Nativia by The Cut was born with this mission in mind. To create an open environment where you can cook, have breakfast, work, study and nurture in the broadest sense by fostering exchanges among people but also among environments, from the living room and beyond, including outdoor spaces, thanks to a wireframe that is more than a simple kitchen component and turns into a vertical vegetable garden.

A project of elegant minimalism, daring in its simplicity, endlessly flexible and fully customisable, and always boasting the unique details and materials of The Cut kitchens.





In their outdoor version, the **Yugen System** frames can be equipped with tank containers for plants. Shown in the picture is a folded component with black finish.





The Cut's **Yugen System** frames can be fastened to a ceiling or wall and are outfitted with shelves, trays, container modules with and without a door and oven-holder modules. Full flexibility that fits in any context.







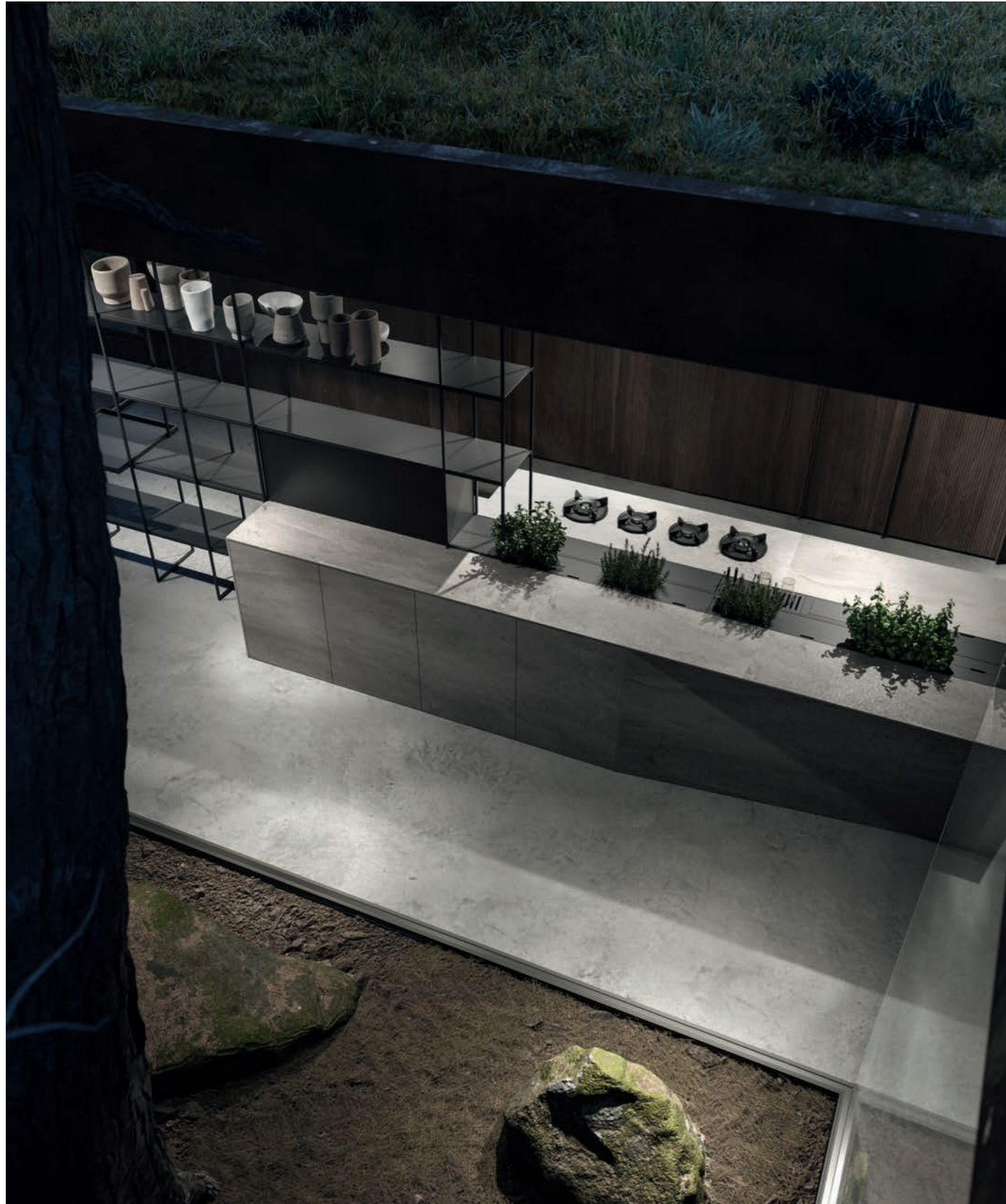

The island features a multifunctional channel with water drainage. It can be combined using modules equipped with electrical outlets, jar and spice holders, plants, kitchen tool holders, as well as dish and glass racks. The channel is available in different sizes and in white, black and grey stainless-steel finishes.



**WHEN LESS IS BEAUTIFUL
AND ASIMMETRY
IS PERFECTION,
THE MOST STRIKING
ELEMENT IS THE SHEER
SIMPLICITY OF FORM.**

The **Yugen System** frames are available in standard white or black finishes or in any finish matching the metal doors.

The accessories are in folded materials and available in a full range of finishes: wood-look melamine-face, lacquered-matte-gloss and ral, HPL laminate, Fenix, veneered, lacquered metal-look and metal.





The **Yugen System** can be customized with bottle racks of the same height and minimalist design finishes as the frames. The bottle racks are available in single and double version with two bottle racks placed side by side.



The sloped top of the island, in addition to bestowing dynamism to the project, provides adequate space for the legs and bar stools when using the kitchen's counter top as a breakfast or aperitif area.









The doors of the island are 12 mm thick **Minima** model doors. Each door features an aluminium honeycomb frame on which a 3 mm thick ceramic slab is installed. This solution ensures lightness, a high-tech appeal and functionality.





**DESIGN IS FUNCTION
AND AWE: IT IS ABOUT
CONCEALING AND
THEN UNVEILING.
BECAUSE IN EVERY
SINGLE MOMENT OF
OUR LIFE WE SEEK
THE SUBTLE PLEASURE
OF THE UNEXPECTED.**

The columns of this Nativia project feature **Linear** doors in solid staved wood with matching handle colour. An equipped wall conceals the kitchen to integrate it seamlessly in any living room.

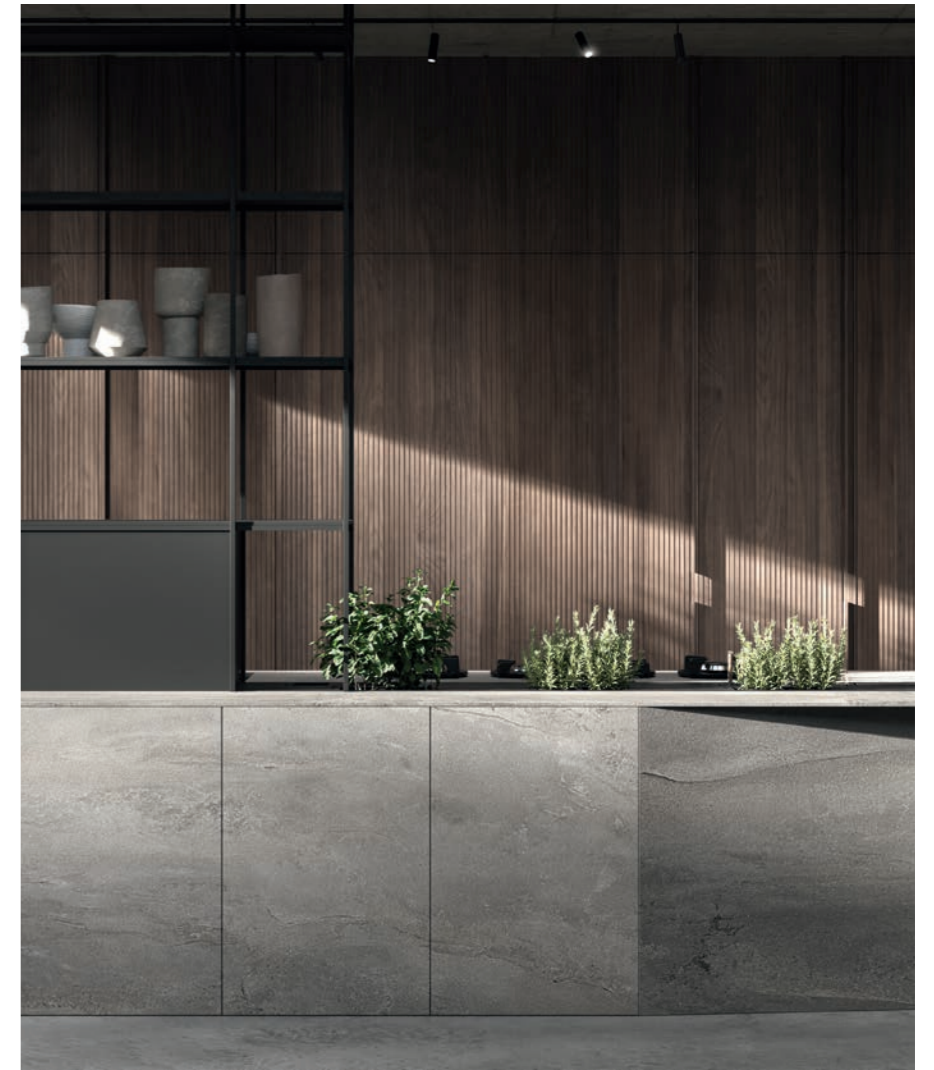

In this project, the **Minima** door is in Vint Gris Natural finish with an elegant texture. Finishes are also available in lacquered-matte gloss and ral, veneered, metallic, ceramics, clay and glass.

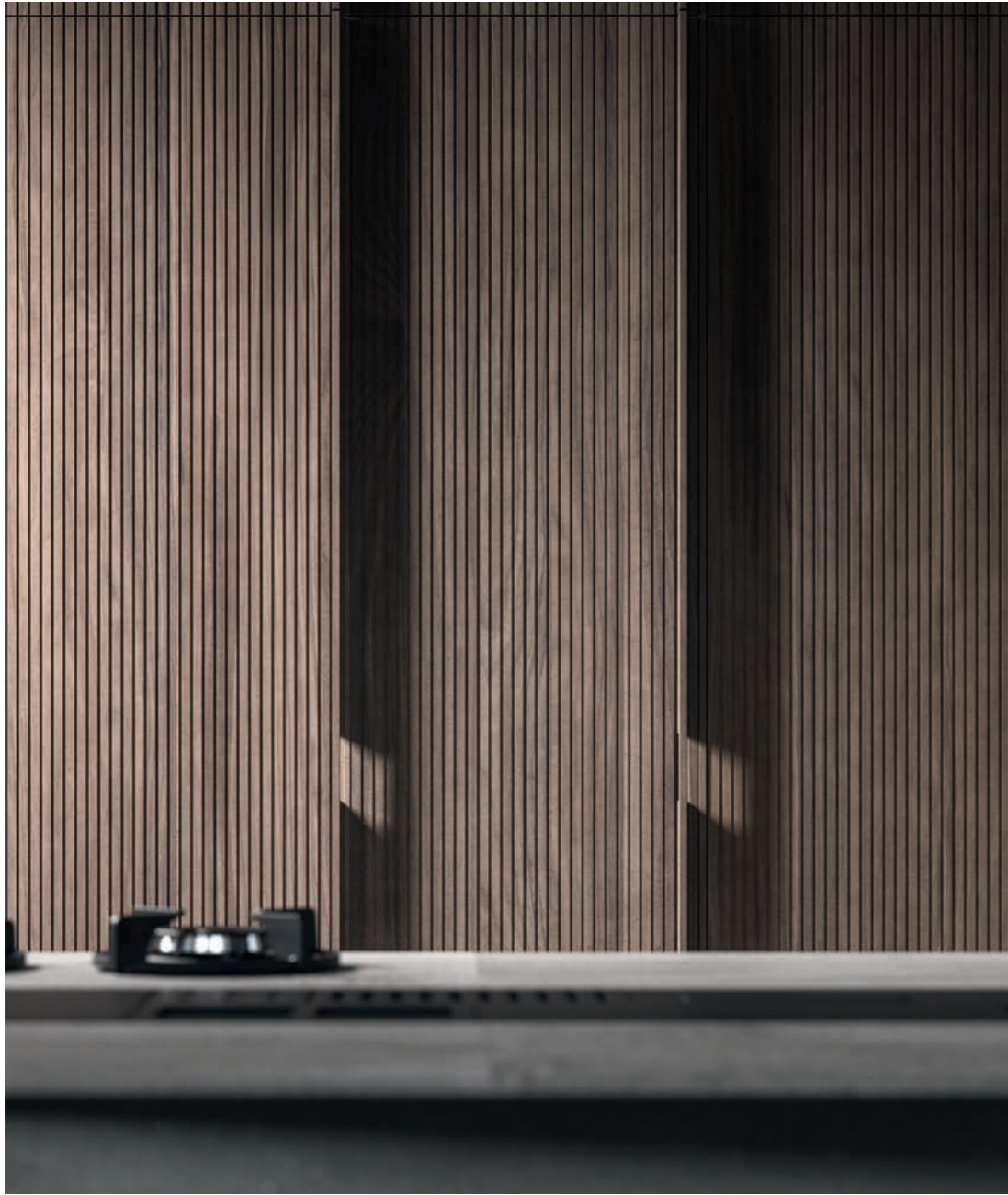

The shelves of the Nativia kitchen column are backlit with Sirenuse lamps. A choice of great visual impact and yet great practicality.

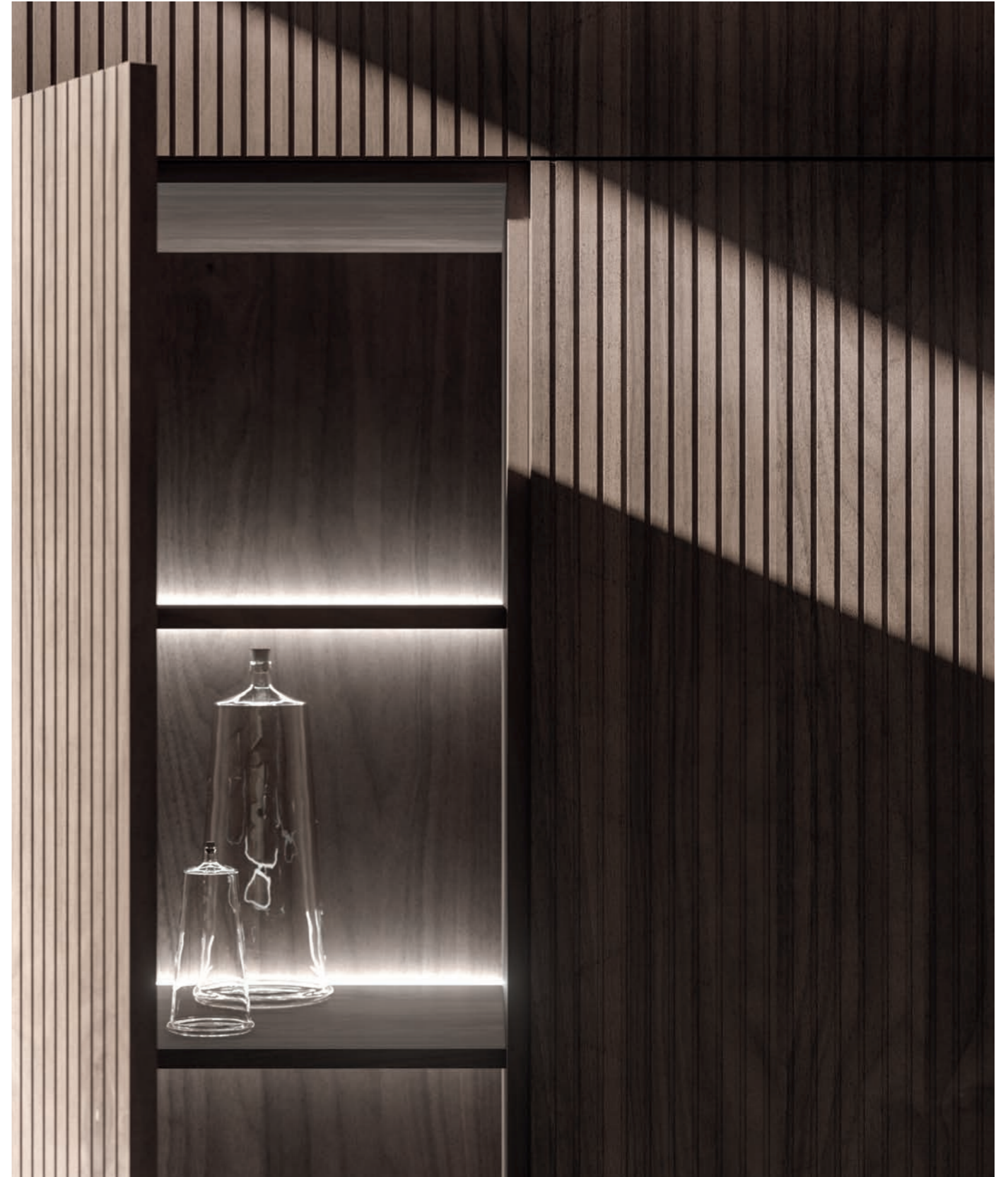



The column in this Nativia project features **Tecno** glass shelves with a black frame and smoke grey glass finish. On request, LEDs can be installed for shelf lighting, as shown in the picture.









Also on request, the **Zen door** glass can be clear or smoke grey. The picture shows the sides of the frame with LED Noor lamps installed and a Pivot hinge in use.





Natura is an
ongoing conversation.

Between home and nature,
aesthetics and usability,
human and technology.

A kitchen becoming
architecture and architecture
becoming a kitchen.



Nativia

Designed by Alessandro Isola
The Cut, Venezia, Italy
thecutkitchen.com

