

# Frame

## Sideboards & cupboards

Salvatore Indriolo, 2018



Sideboard / Madia / Anrichte



Cupboard / Credenza / Küchenbuffet

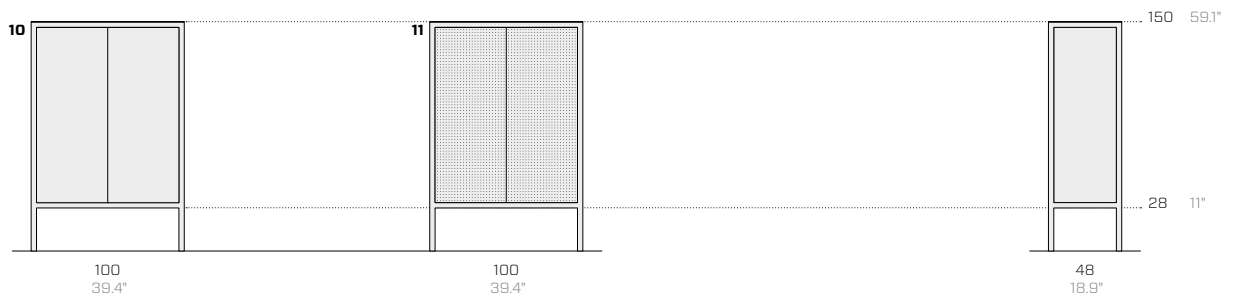

Internal configurations / Configurazioni interne / Konfigurationen der Innenausstattung

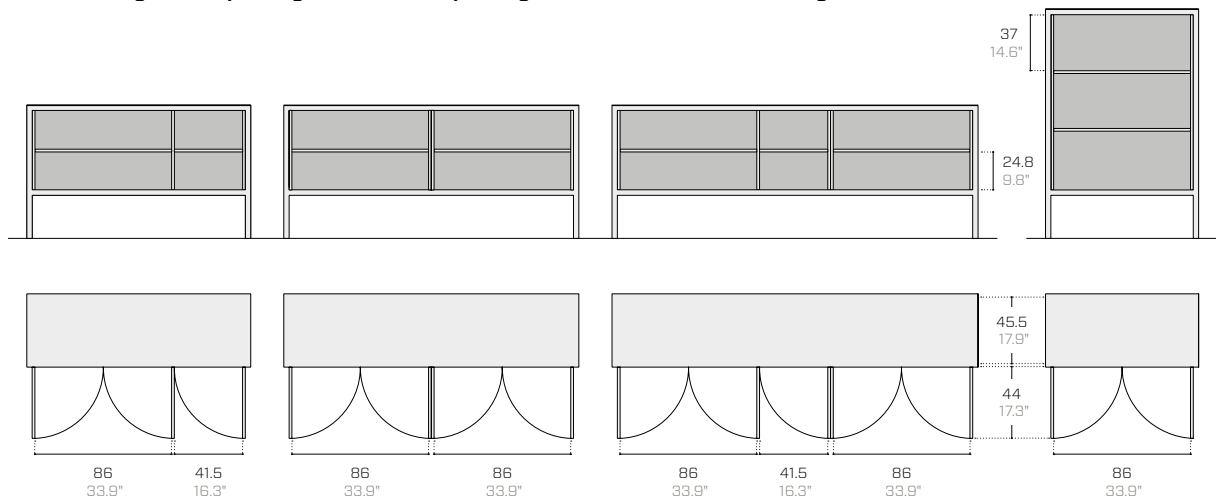

**Product / Prodotto / Produkt**

**Packaging / Imballo / Verpackung**

No.	Code	Dimensions (w-d-h)	Weight	Doors	Dimensions (w-d-h)	Weight	Vol pkg
N.	Codice	Dimensioni (l-p-h)	Peso	Ante	Dimensioni (l-p-h)	Peso	Vol. collo
Nr.	Code	Abmessungen (b-t-h)	Gewicht	Türen	Abmessungen (b-t-h)	Gewicht	Vol. Kollo
		cm	kg		cm	kg	mc

**Sideboard with top made of metal / Madia con top in metallo / Anrichte mit Abdeckung in Metall**

01	FR11	147 48 87	71	3	150 80 107	103	1.30
02	FR12	194 48 87	87	4	200 80 107	130	1.80
03	FR13	240 48 87	108	5	240 80 107	159	2.10
04	FR14	147 48 87	69	3	150 80 107	101	1.30
05	FR15	194 48 87	85	4	200 80 107	128	1.80
06	FR16	240 48 87	105	5	240 80 107	156	2.10
07	FR17	147 48 87	68	3	150 80 107	100	1.30
08	FR18	194 48 87	84	4	200 80 107	127	1.80
09	FR19	240 48 87	103	5	240 80 107	154	2.10

**Cupboard with top made of metal / Credenza con top in metallo / Küchenbuffet mit Abdeckung in Metall**

10	FR20	100 48 150.9	79	2	120 80 170	105	1.70
11	FR21	100 48 150.9	77	2	120 80 170	103	1.70

Backboard w/ provision for Ø 5 cm cable holes / Schiena predisposta per fori passacavi Ø 5 cm / Rückwand vorbereitet für Kabellöcher Ø 5 cm

A1	FRK16S3	- - -	-	-	- - -	-	-
A2	FRK17S4	- - -	-	-	- - -	-	-
A3	FRK18S5	- - -	-	-	- - -	-	-

**Backboard w/ provision for cable holes / Schiena predisposta per fori passacavi / Rückwand vorbereitet für Kabellöcher**

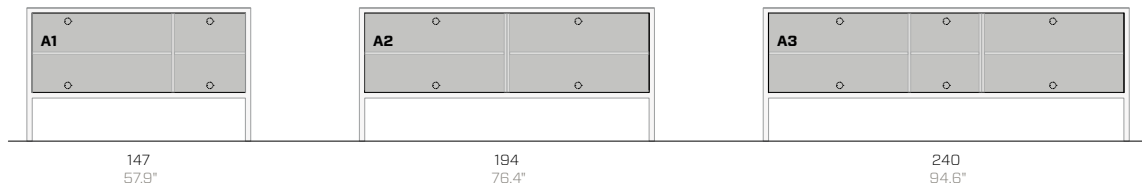

**Positioning of the shelves / Posizionamento dei ripiani / Positionierung der Einlegeböden**

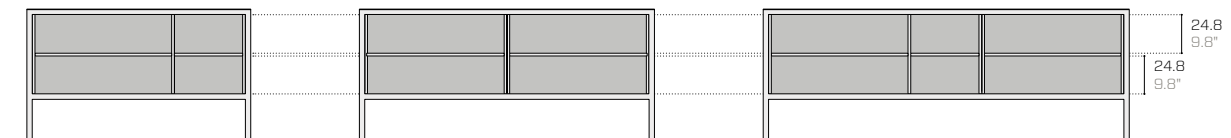

Shelves in standard position / Ripiani in posizione standard / Einlegeböden in Standardposition

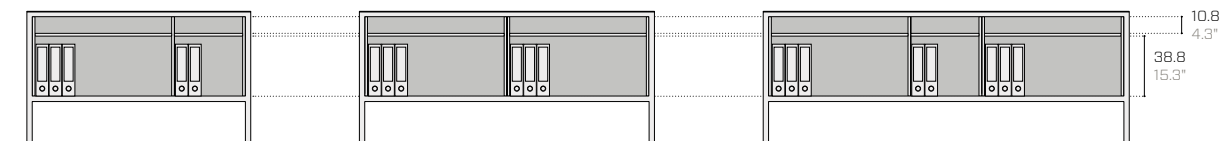

Shelves in raised position (+5.5") / Ripiani in posizione rialzata (+14 cm) / Einlegeböden in angehobener Position (+14 cm)

## Metal essentials

	<p><b>01.18</b> <b>Black (RAL 9005)</b> Nero / Schwarz --- EM ▲■</p>		<p><b>08.20</b> <b>Rose quartz</b> Rosa quarzo / Rosenquarz --- EM ▲</p>		<p><b>15.19</b> <b>Forest green (RAL 6007)</b> Verde bosco / Waldgrün --- EM ▲●</p>
	<p><b>02.18</b> <b>Anthracite (RAL 7021)</b> Antracite / Anthrazit --- EM ▲●■</p>		<p><b>09.18</b> <b>Ruby red (RAL 3003)</b> Rosso rubino / Rubinrot --- EM ▲</p>		<p><b>16.19</b> <b>Turquoise blue (RAL 5018)</b> Blu turchese / Türkisblau --- EM ▲</p>
	<p><b>03.18</b> <b>Fantin grey</b> Grigio Fantin / Fantin-Grau --- EM ▲■</p>		<p><b>10.21</b> <b>Flame red (RAL 3000)</b> Rosso fuoco / Feuerrot --- EM ▲●</p>		<p><b>17.18</b> <b>Pastel blue (RAL 5024)</b> Blu pastello / Pastellblau --- EM ▲</p>
	<p><b>04.18</b> <b>Light grey (RAL 7035)</b> Grigio luce / Lichtgrau --- EM ▲■</p>		<p><b>11.21</b> <b>Melon yellow (RAL 1028)</b> Giallo melone / Melonengelb --- EM ▲●</p>		<p><b>18.21</b> <b>Dusty blue (RAL 5014)</b> Azzurro polvere / Staubiges blau --- EM ▲●</p>
	<p><b>05.19</b> <b>Cloud grey</b> Grigio nuvola / Walkengrau --- EM ▲■</p>		<p><b>12.19</b> <b>Zinc yellow (RAL 1018)</b> Giallo zinco / Zinkgelb --- EM ▲</p>		<p><b>19.18</b> <b>Gentian blue (RAL 5010)</b> Blu genziana / Enzianblau --- EM ▲●</p>
	<p><b>06.18</b> <b>White (RAL 9016)</b> Bianco / Weiß --- EM ▲■</p>		<p><b>13.21</b> <b>Pastel green (RAL 6019)</b> Verde pastello / Weißgrün --- EM ▲●</p>		<p><b>20.19</b> <b>Steel blue (RAL 5011)</b> Blu acciaio / Stahlblau --- EM ▲</p>
	<p><b>07.21</b> <b>Milk white (RAL 9001)</b> Bianco latte / Milchweiß --- EM ▲●■</p>		<p><b>14.18</b> <b>Sage green (RAL 6021)</b> Verde salvia / Salbeigrün --- EM ▲●</p>		<p><b>21.21</b> <b>Coffee brown (RAL 8019)</b> Marrone caffè / Kaffeebraun --- EM ▲</p>

Metal design

Metallic



**41.18  
Gold**  
Oro / Gold  
---  
EM ▲

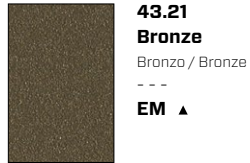

**43.21  
Bronze**  
Bronzo / Bronze  
---  
EM ▲

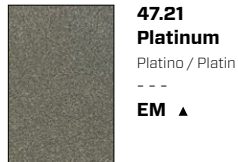

**47.21  
Platinum**  
Platino / Platin  
---  
EM ▲

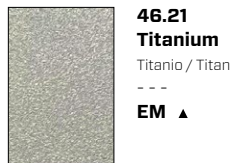

**46.21  
Titanium**  
Titanio / Titan  
---  
EM ▲



**45.21  
Silver**  
Argento / Silber  
---  
EM ▲



**44.18  
Iron**  
Ferro / Eisen  
---  
EM ▲

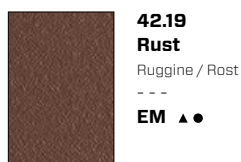

**42.19  
Rust**  
Ruggine / Rost  
---  
EM ▲●

Earth



**51.18  
Sand**  
Sabbia / Sand  
---  
EM ▲●



**57.21  
Clay**  
Creta / Lehm  
---  
EM ▲●

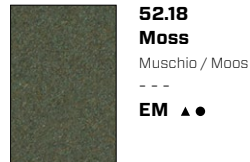

**52.18  
Moss**  
Muschio / Moos  
---  
EM ▲●



**53.18  
Basalt**  
Basalto / Basalt  
---  
EM ▲●

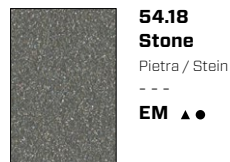

**54.18  
Stone**  
Pietra / Stein  
---  
EM ▲●

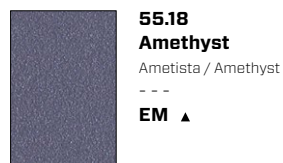

**55.18  
Amethyst**  
Ametista / Amethyst  
---  
EM ▲

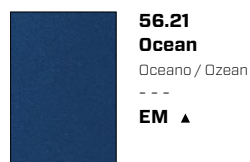

**56.21  
Ocean**  
Oceano / Ozean  
---  
EM ▲

Surfaces / Superfici / Oberflächen

EM Embossed / Goffrato / Gaufriert

Use / Utilizzo / Verwenden

- ▲ Tops / Top / Arbeitsplatte
- Outdoor / Esterni / Außenbereich
- Food / Alimentare / Lebensmittel

---

**Technical information**

**Metal** Non-toxic powder coating for interior use, with no heavy metals. Cured in an oven at 190 °C, following degreasing and phosphating. Guaranteed minimum thickness of 50 microns. Minimum resistance to salt spray of 200 hours (in accordance with the ASTM B117 standard). Some finishes are suitable for direct contact with food as required by Italian Law Decree D.M. 21/03/73 and subsequent updates. Requests for other RAL finishes can be considered.

---

**Informazioni tecniche**

**Metallo** Verniciatura per interni a polveri atossiche prive di metalli pesanti, con passaggio in forno a 190 °C, previo trattamento di sgrassaggio e fosfatazione. Spessore minimo garantito 50 micron, resistenza minima in nebbia salina pari a 200 ore (norma ASTM B117). Alcune finiture sono idonee al contatto diretto con alimenti come previsto dal decreto italiano D.M. 21/03/73 e successivi aggiornamenti. Altre finiture RAL valutabili su richiesta.

---

**Technische Informationen**

**Metall** Die Pulverbeschichtung der gift- und schwermetallfreien Pulverlacke für Innenbereiche erfolgt im Lackierofen bei 190 °C nach vorheriger Entfettung und Phosphatierung. Die garantierte Mindeststärke der Lackschicht beträgt 50 Mikron bei einer Mindestprüfungsdauer von 200 Stunden im Salznebel (ASTM-Norm B117). Einige Oberflächen sind für den direkten Kontakt mit Lebensmitteln geeignet, wie in der Verordnung vorgesehen Italienisch D.M. 21/03/73 und folgende Aktualisierungen. Auf Anfrage können andere RAL-Finishes in Betracht gezogen werden.

**Sideboards and cupboards from the Frame range, with a visible support structure and inset doors that are distinguishing visual features of the minimal design scheme.**

**Welded single-piece frame** made of 35 x 35 mm (1.38" x 1.38") square tubes. Concealed adjustable feet.

**Top** made of metal with a thickness of 3 mm (0.19") and a bottom fibreboard filler panel.

**Push-pull doors** inset in the frame, made of bent and filled sheet metal. Door thickness: 20 mm (0.79"). Soft-close dampening hinges. Perforated version: holes with a diameter of 5 mm (0.20") at 10 mm (0.39") intervals.

**Sides and bases** inset in the frame, made of bent sheet metal; filled sides.

**Metal backboards** inset in the frame. Optional backboards with the provision for cable holes.

**Bent metal internal shelves** with a capacity of 25 kg (evenly distributed).

The sideboards and cupboards with 3 doors are ready assembled. Sideboards with 4 or 5 doors are ready assembled but the doors come separately.

**Madie e credenze del programma Frame, caratterizzato dal telaio portante in vista e ante in luce, che diventano caratteristiche estetiche dal design minimale.**

**Telaio monoblocco saldato** in tubolare quadrato 35 x 35 mm (1.38" x 1.38"). Piedini invisibili regolabili.

**Top** in metallo di spessore 3 mm (0.19") con tamponamento inferiore in fibre di legno.

**Ante push-pull** in luce al telaio, in lamiera piegata e tamponata. Spessore delle ante 20 mm (0.79"). Cerniere ammortizzate. Nella versione con forature: fori diametro 5 mm (0.20") con passo 10 mm (0.39").

**Fianchi e fondi** in luce al telaio, in lamiera piegata; fianchi tamponati.

**Schiene** in metallo in luce al telaio. Schiene opzionali con predisposizione per fori pas-sacavi.

**Ripiani** interni in lamiera piegata, con portata di 25 kg uniformemente distribuiti.

Credenza e madia a 3 ante vengono fornite montate. Madie a 4 o 5 ante vengono fornite montate ma con ante a parte.

**Anrichten und Küchenbuffets aus der Frame-Linie mit sichtbarem Tragegestell und bündigen Türen, die zu den ästhetischen Eigenschaften eines Minimaldesigns werden.**

**Einteiligen, geschweißten Gestell** aus Vierkantrohr 35 x 35 mm (1.38" x 1.38"). Unsichtbare, einstellbare Füße.

**Abdeckung** aus 3 mm (0.19") starkem Metall mit unterer Holzfaserdämmung.

**Push-Pull-Türen** aus gedämmtem Falzblech, bündig mit dem Gestell. Stärke der Türen 20 mm (0.79"). Gedämpfte Scharniere. In der gelochten Ausführung: Bohrlöcher 5 mm (0.20") mit 10 mm Abstand.

**Seiten und Basen** aus Falzblech, bündig mit dem Gestell; gedämmten Seiten.

**Rückwände** aus Metall, bündig mit dem Gestell. Optionale Rückwände mit vorgerichteten Bohrungen für die Kabeldurchführung.

**Innere Einlegeböden** aus Falzblech mit einer Tragfähigkeit von 25 kg bei gleichmäßiger Verteilung des Gewichts.

Küchenbuffet und Anrichte werden montiert geliefert. Anrichten mit 4 oder 5 Türen sind bei der Lieferung montiert, aber die Türen sind separat.

#### Disclaimer / Esclusione di responsabilità / Haftungsausschluss

Fantin Srl reserves the right to change the dimensions and features of the products contained in this technical data sheet at any time and without prior notice. The finishes illustrated are purely indicative as the accuracy tolerances of printing processes should be taken into account.

Fantin Srl si riserva la facoltà di modificare in qualsiasi momento e senza preavviso le dimensioni e l'esecuzione dei prodotti contenuti nella presente scheda tecnica. Le finiture riportate hanno valore indicativo in quanto soggette alle tolleranze dei processi di stampa.

Fantin Srl behält sich das Recht vor, die angegebenen Maße und Ausführungen der Produkte, welche dieses Produktblatt enthält, jederzeit ohne Vorankündigung zu ändern. Aufgrund drucktechnischer Abweichungen dienen die dargestellten Ausführungen nur der Illustration.

#### Fantin Srl

via San Vito, 43  
33080 - Bannia  
di Fiume Veneto (PN)  
Italia

t +39 0434 959 133  
f +39 0434 560 037  
fantin@fantin.com  
www.fantin.com



UNI EN ISO 9001