

Parentesit Freestanding

Design by Lievore Altherr Molina, 2016

Art. 5106

Freestanding module made up of a round and a square panel upholstered in one color fabric, with the choice of a different color for one panel, and resting on a matt black metal base. The internal decorative panels have sound absorption features. Fixing plate and connection kit are supplied separately for the creation of modular compositions.

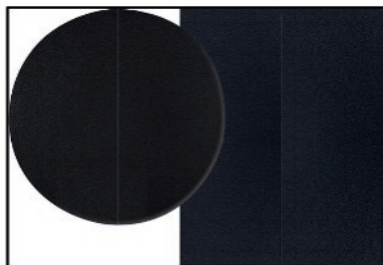

Frame Base



V39
matt

Shell



Polypropylene

Carded In



Canvas
Kvadrat



Cava 3
Kvadrat



Clara 2
Kvadrat



Divina 3
Kvadrat



Divina MD
Kvadrat



Divina Melange 2
Kvadrat



Field
Kvadrat



Fiord
Kvadrat



Floyd
Kvadrat



Hallingdal 65
Kvadrat



Pause 4
Kvadrat



Pro 3
Kvadrat



Remix 2
Kvadrat



Revive 1
Kvadrat



Rime
Kvadrat



Savanna
Kvadrat



Scuba
Kvadrat



Steelcut 2
Kvadrat



Steelcut Trio 2
Kvadrat



Tempo
Kvadrat



Tonus 4
Kvadrat



Umami
Kvadrat



Jet
Fidivi



Style
Fidivi

Graded In

kvadrat

camira



**DESIGN
TEX**

maharam

Gabriel



svensson

arper

info@arper.com

www.arper.com

Parentesit Freestanding

Design by Lievore Altherr Molina, 2016

Art. 5106

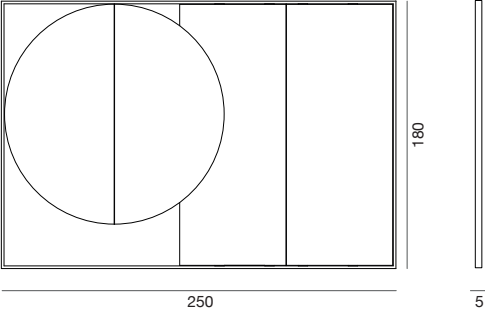

arper

www.arper.com

info@arper.com

Parentesit Freestanding

Design by Lievore Altherr Molina, 2016

Accessories:

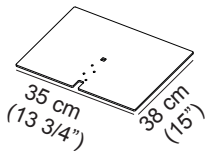

Standard single plate Art.
5108

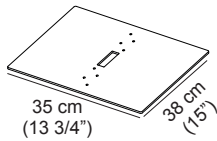
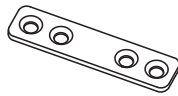
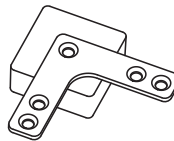

Plate single junction Art.
5109



Link kit for linear modules Art.
5110



Link kit for "L" modules Art.
5111

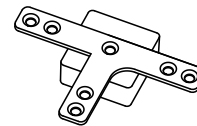

Link kit for "T" modules Art.
5112

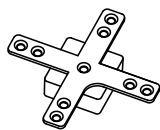

Link kit for "+" modules Art.
5113

SHIPMENT DETAILS

Art.5106

1 pz = 3  - kg 59/ m³ 0,35

TECHNICAL SPECIFICATIONS

Art.5106

H 140 cm. COM Meterage ml 8,43

arper

www.arper.com

info@arper.com